

DOBERMAN PINSCHERS, CHINESE CRESTEDS & CHOW CHOWS ARE LIMITED TO 100 ENTRIES AT THE CONCURRENT SPECIALTY & ALL BREED SHOW THE DAY OF THE CONCURRENT

ENTRIES CLOSE WEDNESDAY NOON, SEPTEMBER 27, 2017 or when the numerical limit has been reached, if reached prior to this date at Superintendent's Office. After which time entries cannot be accepted, cancelled, altered or substituted except as provided for in Chapter 11, Section 6 of the Dog Show Rules.

PREMIUM LISTS

All Breed Dog Shows



of Tennessee

Licensed by the American Kennel Club

FRIDAY, OCTOBER 13, 2017 - SEE SEPARATE PREMIUM LIST

NATIONAL SPECIALTIES • United States Neapolitan Mastiff Club • Puli Club of America, Inc.
INDEPENDENT SPECIALTIES • East Tennessee Boxer Club • Chinese Crested Club of Nashville

SATURDAY, OCTOBER 14, 2017 - 2017607001

SUNDAY, OCTOBER 15, 2017 - 2017607002

CONCURRENT SPECIALTIES (SATURDAY) - SEE SEPARATE PREMIUM LISTS

Doberman Pinscher Club of Nashville
Chinese Crested Club of Nashville
Middle Tennessee Chow Chow Fanciers

DESIGNATED REGIONAL SPECIALTY SHOW - SATURDAY

Puli Club of America, Inc. - 2017005713

DESIGNATED SPECIALTY SHOW - SATURDAY

United States Neapolitan Mastiff Club - 2017616507

SUPPORTED ENTRIES - SATURDAY

Rhodesian Ridgeback Club of the United States • America Toy Fox Terrier Club

SUPPORTED ENTRIES - SUNDAY

United States Neapolitan Mastiff Club • Puli Club of America, Inc.

SUPPORTED ENTRIES - BOTH DAYS

Cumberland Valley Dachshund Club • East Tennessee Boxer Club
Doberman Pinscher Club of Nashville • Chinese Crested Club of Nashville
Havanese Club of America • Music City Bulldog Club • Middle Tennessee Chow Chow Fanciers

AKC NATIONAL OWNER HANDLED SERIES - BOTH DAYS

Wilson County Exposition Center

945 East Baddour Parkway, Lebanon, Tennessee 37087

THESE SHOWS WILL BE HELD INDOORS • UNBENCHED

SHOW HOURS: 6:30 am to 11:00 pm CDT

The Tri-Star Kennel Club of Williamson County Tennessee is pleased to offer these Concurrent Specialty Shows included on page 1. Allowing exhibitors the opportunity to exhibit twice during the day.

Please see separate Premium Lists for details.

ENTRY FEES • (including 50 cent AKC recording fee and \$3.00 AKC Event Service Fee)

Separate fee for each dog, each day

| | |
|--|----------------|
| First entry of each dog | \$29.00 |
| Additional entry of same dog, unless otherwise specified | \$20.00 |
| Puppy Classes | \$20.00 |
| Junior Showmanship Competition | FREE |
| Rhodesian Ridgeback Sweepstakes & Veteran Sweepstakes (Saturday) | \$15.00 |
| Neapolitan Mastiff Sweepstakes & Veteran Sweepstakes (Saturday) | \$20.00 |
| Puli Sweepstakes & Veteran Sweepstakes (Saturday) | \$20.00 |

When a dog is entered in more than one class, the highest priced class is considered the first entry.

NOTICE: PLEASE PUT BREED & NAME OF SHOW ON CHECK.

OFFICERS

| | |
|---------------------------|-------------------------|
| Judy Russell | President |
| Chawnecy Vaughn | Vice President |
| William "Bill" Neil | Treasurer |
| Thomas Wright | Recording Secretary |
| Tim McCormack | Corresponding Secretary |

107 Sunny Meade Dr, Mt Juliet TN 37112

BOARD OF DIRECTORS

Bruce Jackson • Carol Clouse • Claudia Seaberg • Kathy Lyons • Sally Sklar
 S M "Dick" Dickerson - Lifetime Board Member
 Bobbie Wilhoite - Lifetime Board Member

SHOW COMMITTEE

| | |
|---|---|
| Thomas Wright | Show Chairman |
| 8024 Bill Moss Rd, White House TN 37188 • tomjo43@aol.com • (615) 477-7044 | |
| Judy Russell | Assistant Show Chairman |
| Chawnecy Vaughn | Assistant Show Chairman - Specialties & Supported Entries |
| Officers of the Club & Members of the Board of Directors | |

COMMITTEES

| | |
|--|------------------------|
| Claudia Seaberg | Ring Hospitality |
| Peggy B Wright | Show Tours |
| Carol Clouse | Vendors |
| Bett Pilling | Public Relations |
| Paul Hines & Bryan McMillen | Grooming |
| Margaret DiCorleto | Public Education Booth |
| Peggy B Wright | Advertising |
| Tondalea Wright | Chief Ring Steward |
| Tim McCormack | Trophies |
| Margaret DiCorleto, Chawnecy Vaughn, Thomas Wright | Bench Show Committee |
| Judy Russell & Claudia Seaberg | |

Best in Stewards - Hassle Free Stewarding

8024 Bill Moss Rd, White House TN 37188 • (615) 478-0558 • twright4343@gmail.com



CERTIFICATION

Permission has been granted by the American Kennel Club for the holding of this event under the American Kennel Club rules and regulations.

**AMERICAN
KENNEL CLUB**

GINA M. DINARDO, Executive Secretary

SHOW PHOTOGRAPHER

Don Meyer Dog Show Photographers • (636) 239-1402
3626 Dunn Spring Rd, Labadie MO 63055

SHOW VETERINARIANS

(ON CALL Friday & In Attendance Saturday & Sunday)
Animal Wellness Center • Dr Julia Adams • (615) 683-6600
259 Jmz Dr, Gordonsville TN 38563

DIRECTIONS TO ANIMAL WELLNESS CENTER- Take I-40 E to Exist 258 Carthage. Turn right to Jmz Dr. Animal Wellness Center is on the left.

Cumberland Animal Hospital • Charles Allen • (615) 444-1232
1975 Lebanon Rd, Lebanon TN 37087

DIRECTIONS TO CUMBERLAND ANIMAL HOSPITAL- Go away from Interstate on US 70/TN 26 toward Hartman Dr (1.1 miles). Turn right to stay on US/TN 26/W Main St (1.2 miles). Last intersection you pass is Waters Hill Cir. If you reach Bethlehem Rd, you have gone too far.

EMT

will be on site from 8:00 am to 5:00 pm FRIDAY, SATURDAY & SUNDAY

RV & OVERNIGHT PARKING/CAMPING

All Camping & RV Parking will be allowed in designated areas only as per Fairgrounds guide lines. All parking regulations will be strictly enforced. Violators will be asked to move or their vehicles will be towed at the owner's expense! The Fairgrounds has dump sites for motorhomes. No open dumping. There are plenty of restrooms with showers at the fairgrounds. All exhibitors parking or camping are required to clean up after themselves & their dogs.

The Tri-Star Kennel Club of Williamson County, TN, Members, Directors, Officers, Agents, Superintendent and/or employees of Wilson County will not be liable for any loss or injury which may be sustained through the disappearance, loss, theft, injury and/or death that are caused by the negligence or carelessness of the individual person. Tri-Star Kennel Club of Williamson County, TN, Members, Directors, Officers, Agents, Superintendent and/or employees of Wilson County will not be responsible for negligence by any person(s) or by any other causes.

We have plenty of RV parking at our new facility. Each RV area will have electricity and water. Contact Kathy Lyons or Linda Winford by email (soridge@aol.com) or phone (931) 216-3600, 1559 Old Dotsonville Rd, Clarksville TN 37042 to secure your parking space. This year's cost will be \$35.00 per night. Please make checks payable to Tri-Star Kennel Club (TSKCW).

Member: Dog Show Superintendents Association



American
Kennel Club
Annually Licensed
Superintendents

Jill M Bell • John Goosen • Candy E James • Christopher L James
H T (Terry) James • Mary Beth James • Tim E James • Matthew Mantooth
John McDonald • Antony M Onofrio • Jack David Onofrio • Patricia Onofrio
Sue Onofrio • Tiffany R Fields Peterson • Glen Power • Reggie Turner
Sharon Turner • Greg S Wetmore

PO Box 25764
Oklahoma City, Oklahoma 73125-0764
Phone: (405) 427-8181 • www.onofrio.com

PO Box 4660
Portland, Oregon 97208-4660

**TOTAL EXPO CENTER
78,600 SQ. FT.**

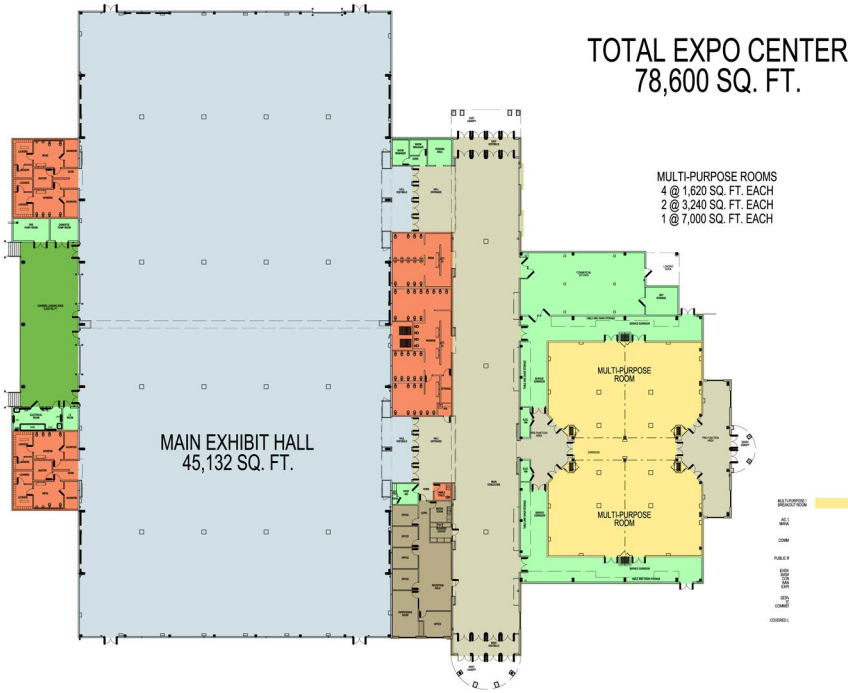

PARKING LOTS

There will be no charge for parking.

Wilson County Exposition Center - Directions

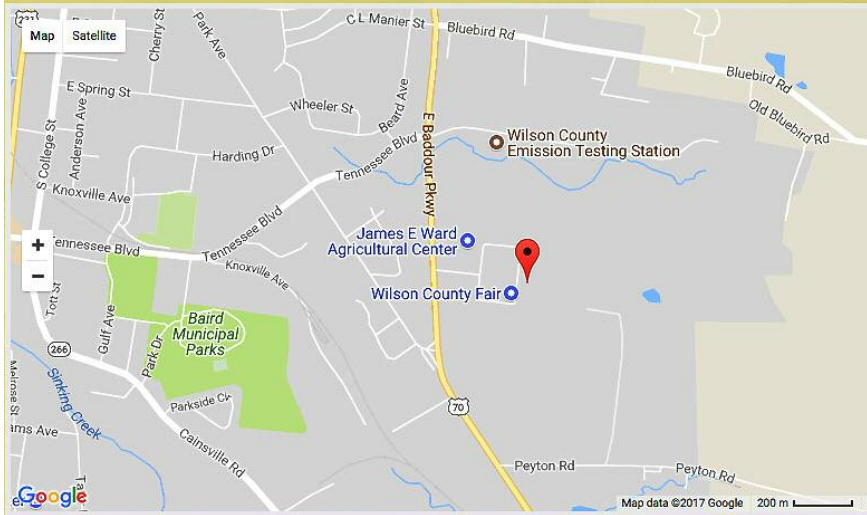

We have MOVED!!!

New 2017 Show Site

**Wilson County Exposition Center
945 East Baddour Pkwy
Lebanon TN 27087**

<http://wilsoncountyexpo.com/view-our-facility>

- Less than one mile off I-40.
- 15 hotels less than 1 mile from show site.
- 1000 RV hook-ups with water and electricity.
- Numerous restrooms and showers.
- 2-3500 sq ft meeting room.
- Wash area for dogs.
- 45,000 sq ft exhibition floor.
- Electrical plugs in exhibition floor.
- Plenty of indoor grooming areas for everyone.

ROUTES TO THE SHOW

FROM THE WEST (Memphis Area) - Take I-40 East to toward Knoxville. Take exit 239B (US 70/Sparta Pike) toward Lebanon. Go 1 mile to James E Ward Center (Wilson County Exposition Center) will be on the right.

FROM THE EAST (Knoxville Area) - Take I-40 West toward Nashville. Take Exit 239 for US 70 toward Lebanon/Watertown. Turn right onto US 70 W/Sparta Pike (signs for Lebanon/Ward Center), go 1 mile, Fairgrounds will be on the right.

FROM THE SOUTHEAST (Murfreesboro, Chattanooga, Atlanta) - Take I-24 West toward Nashville. Take exit 74B for TN 840E toward Lebanon/Knoxville. Take exit 76A to merge onto I-40 E toward Lebanon/Knoxville. Take exit 239B (US 70/Sparta Pike) toward Lebanon. Go 1 mile to James E Ward Center (Wilson County Exposition Center) will be on the right.

FROM THE NORTHWEST (Clarksville, Ft Campbell) - Take I-24 East toward Nashville. Follow signs for I-40 E/Knoxville. Take exit 239B (US 70/Sparta Pike) toward Lebanon. Go 1 mile to James E Ward Center (Wilson County Exposition Center) will be on the right.

FROM THE SOUTH (Alabama) - Take I-65 North to Exit 59A for TN 840 E toward Murfreesboro/Knoxville. Take Exit 76A to merge onto I-40 E toward Lebanon/Knoxville. Take exit 239B (US 70/Sparta Pike) toward Lebanon. Go 1 mile to James E Ward Center (Wilson County Exposition Center) will be on the right..

FROM THE NORTH (Bowling Green, Kentucky, Indiana) - Take I-65 South to Nashville. Continue to follow I-40 E to Knoxville. Take exit 239B (US 70/Sparta Pike) toward Lebanon. Go 1 mile to James E Ward Center (Wilson County Exposition Center) will be on the right.

ACCOMMODATIONS

Confirm with Hotels on specific pet policy. Some facilities have fees & size limitations.

HOTEL GROUNDS ARE CONSIDERED PART OF THE SHOW GROUNDS

Please make your reservations as soon as possible due to multiple events in the area. Anyone who abuses privileges of a hotel will have an Event Committee hearing.

| | |
|--|----------------|
| LaQuinta Inn | (615) 470-1001 |
| 140 Dixie Ave, Lebanon TN 37090 • Mention TSKC when making reservations | |
| Red Roof Inn | (615) 872-0735 |
| 510 Claridge Dr, Donelson TN 37214 • 22 miles from show site | |
| Quality Inn | (615) 444-7020 |
| 641 S Cumberland St, Lebanon TN 37087 | |
| Days Inn | (615) 449-5781 |
| 822 S Cumberland St, Lebanon TN 37090 | |
| Ramada Inn | (615) 444-7400 |
| 704 S Cumberland St, Lebanon TN 37087 • Must mention TSKC for special prices | |
| Quality Inn | (615) 451-4494 |
| 1001 Village Green Crossing, Gallatin TN 37066 • approximately 16 miles from show site | |
| Rodeway Inn | (615) 683-1300 |
| 479 Gordonsville Hwy, Gordonsville TN 38563 | |
| Sleep Inn | (615) 449-7005 |
| 150 S Eastgate Ct, Lebanon TN 37090 | |
| Red Roof Inn | (615) 893-0104 |
| 2282 Armory Dr, Murfreesboro TN 37129 • approximately 34 miles from show site | |
| Motel 6 | (615) 890-8524 |
| 148 Chaffin Place, Murfreesboro TN 37129 • approximately 34 miles from show site | |

SATURDAY & SUNDAY EXHIBITORS ONLY

Free Coffee & Donuts while they last

Designated Area

RAFFLE

4000 Peak/3200 Running Watts, 6.5 HP (212cc) Predator Generator or equal value offered by Randy Mcateer

Tickets: \$1.00 each • 6 for \$5.00

15 for \$10.00 • 30 for \$20.00

AKC NATIONAL OWNER-HANDLED SERIES SATURDAY & SUNDAY

The AKC National Owner-Handled Series is a non-titling competition for dogs that are exhibited by their owners that are not professional handlers.



“DON'T FORGET TO CHECK THE OWNER-HANDLED BOX ON THE ENTRY FORM IF ENTERING THIS COMPETITION.”



All dogs that are owner-handled and are not exhibited in the National Owner-Handled Series by professional handlers* meet the requirements for this competition. Exhibitors must declare their dog is Owner-Handled eligible at the time of entry using the check box on the entry form. Eligible dogs will be identified by an asterisk in the steward's book & the catalog. **Dogs must be handled throughout the breed level competition for the regular show by an eligible owner. Professional handlers, household members and current assistants** to professional handlers may not exhibit the dog in any AKC National Owner-Handled Series competition during the entire show.**

Owner-Handled Best of Breed will be selected from the dogs that are competing in the Best of Breed competition including Winners Dog, Winners Bitch and winners of the non-regular classes.

The breed will not be represented in the Owner-Handled Group if there is no eligible dog competing in the Best of Breed, or in Best of Winners competition.

**Professional handlers are defined as any person who belongs or has belonged to a professional handlers' organization, distributed rate cards, or otherwise advertised or represented themselves as handling dogs for pay within the last five years.*

***A current assistant is defined by anyone employed by a professional handler on a full-time basis, or assisting a professional handler at the show or any during the cluster/weekend.*

If ELIGIBLE dog wins award indicated by ✓ at the top it eliminates those marked with an X.

| | Best of Breed | BOB Dog | BOB Bitch | Select Dog | Select Bitch | BW Dog | BW Bitch |
|-----------------------|---------------|---------|-----------|------------|--------------|--------|----------|
| Dog wins eliminates X | ✓ | ✓ | ✓ | ✓ | ✓ | ✓ | ✓ |
| Special Dogs | X | X | | X | | | |
| Special Bitches | X | | X | | X | | |
| Winners Dog | X | X | | | | | X |
| Winners Bitch | X | | X | | | X | |
| Non-Reg Dogs | X | X | | X | | | |
| Non-Reg Bitches | X | | X | | X | | |

AKC FAST-CAT TULLAHOMA KENNEL CLUB, INC.

Friday, Saturday & Sunday

Trial Chairman - Janet Willis
Trial Secretary - Debbie Hill

Entries can be mailed to:
Debbie Hill at 107 Mosby Ct, Shelbyville TN 37160

Entry Fees: Pre-entry - \$20.00 • Day of Trial - \$25.00

• RIBBON/ROSETTE PRIZES WILL BE AS FOLLOWS •

| REGULAR CLASSES | |
|---|----------------------|
| First Prize..... | Blue |
| Second Prize..... | Red |
| Third Prize..... | Yellow |
| Fourth Prize..... | White |
| Winners..... | Purple |
| Reserve Winners..... | Purple and White |
| Best of Winners..... | Blue and White |
| Best of Breed..... | Purple and Gold |
| Best of Variety of Breed..... | Purple and Gold |
| Best of Opposite Sex to Best of Breed and to Best of Variety of Breed..... | Red and White |
| Select..... | Light Blue and White |

| VARIETY GROUPS | |
|---------------------------|--------------------------|
| First Prize..... | Blue |
| Second Prize..... | Red |
| Third Prize..... | Yellow |
| Fourth Prize..... | White |
| Best in Show..... | Baby Blue, Red and White |
| Reserve Best in Show..... | Black and Gold |

| NON-REGULAR CLASSES | |
|---------------------|-------------|
| First Prize..... | Rose |
| Second Prize..... | Brown |
| Third Prize..... | Light Green |
| Fourth Prize..... | Gray |

• CLASSIFICATION •

Regular Classes

Puppy, Dogs
6 months & under 9 months
9 months & under 12 months
Twelve to Eighteen Month, Dogs
Novice, Dogs
Amateur-Owner-Handler, Dogs
Bred-by-Exhibitor, Dogs
American-bred, Dogs
Open, Dogs
WINNERS, DOG

Puppy, Bitches
6 months & under 9 months
9 months & under 12 months
Twelve to Eighteen Month, Bitches
Novice, Bitches
Amateur-Owner-Handler, Bitches
Bred-by-Exhibitor, Bitches
American-bred, Bitches
Open, Bitches
WINNERS, BITCH

Best of Breed (Variety) Competition

The above classification is provided for all breeds (and varieties). Additional divisions, i.e. (age, color or weight) are in the breed list and must be indicated on the entry.

(O) OPEN CLASS DIVISIONS

DACHSHUNDS (ALL THREE VARIETIES): Miniature - 11 lbs & under & 12 mos old or over; Standard - Over 11 lbs & 11 lbs & under if less than 12 mos old

BOXERS: Brindle; Fawn

DOBERMAN PINSCHERS: Black; AOAC

GREAT DANES: Brindle; Fawn; AOAC (Black, Blue, Harlequin, Mantle)

BOSTON TERRIERS: Under 15 lbs; 15 lbs & over

AUSTRALIAN SHEPHERDS: Blue Merle; Black; Red Merle; Red

COLLIES (ROUGH): Blue Merle; Sable & White; Tri-Color; White

SHETLAND SHEEPDOGS: Sable & White; AOAC

FOR NEAPOLITAN MASTIFF & PULI ON SATURDAY

NON-REGULAR (ADDITIONAL) CLASSES Involving Single Dog Entries

***VETERAN DOG CLASS** - A Class for Dogs seven (7) years or older.

***VETERAN BITCH CLASS** - A Class for Bitches seven (7) years or older.

***Neapolitan Mastiffs** - six (6) years or older.

Saturday and Sunday Show Tours Sign up Sheets
at Catalog Table, **9:00 am and 11:00 am.**

Meet the Breeds
Saturday at **11:00 am.**

JUNIOR SHOWMANSHIP COMPETITION

NOVICE JUNIOR CLASS - For Boys and Girls at least 9 and under 12 years of age on the day of the show who at the time entries close, have not won three (3) first place awards, with competition present, in a Novice Class at a licensed or member show.

NOVICE INTERMEDIATE CLASS - For Boys and Girls at least 12 and under 15 years of age on the day of the show who at the time entries close, have not won three (3) first place awards, with competition present, in a Novice Class at a licensed or member show.

NOVICE SENIOR CLASS - For Boys and Girls at least 15 and under 18 years of age on the day of the show who at the time entries close, have not won three (3) first place awards, with competition present, in a Novice Class at a licensed or member show.

OPEN JUNIOR CLASS - For Boys and Girls at least 9 and under 12 years of age on the day of the show who at the time entries close, have won three (3) first place awards in a Novice Class at a licensed or member show, with competition present in the Novice Class.

OPEN INTERMEDIATE CLASS - For Boys and Girls at least 12 and under 15 years of age on the day of the show who at the time entries close, have won three (3) first place awards in a Novice Class at a licensed or member show, with competition present in the Novice Class.

OPEN SENIOR CLASS - For Boys and Girls at least 15 and under 18 years of age on the day of the show who at the time entries close, have won three (3) first place awards in a Novice Class at a licensed or member show, with competition present in the Novice Class.

MASTER CLASS - For Boys and Girls at least 9 and under 18 years of age on the day of the show and who have won ten (10) Best Junior Handler awards with competition. The calendar for this class will be consistent with the eligibility dates for the AKC National Championship. All juniors meeting the criteria for this class are required to enter the Master Class and may change their entry the day of the show if entries have already closed. Once the eligibility time frame for that year has passed, all participants return to the Open Class to compete for the following year.

NOTICE: Junior Handlers must include their AKC JUNIOR HANDLER NUMBER on each entry.

You may obtain your junior identification number by calling the AKC, Judges Education Department, (919) 233-9767.

BE SURE ALL INFORMATION for Junior Showmanship Classes is entered on front and back of entry form.

JUDGES

| | |
|-------------------------------|--|
| Mrs Peggy Dillard Carr | 2501 Goose Creek Bypass, Franklin TN 37064 |
| Mr Oscar Illescas | 1316 Catawba St, Kingsport TN 37660 |
| Dr Sophia Kaluzniacki | 220 E Duval Rd, Green Valley AZ 85614 |
| Mr Thomas L Kirstein | 945 N Main Street, Bulls Gap TN 37857 |
| Mr Garry K Newton | 10519 Hidden Lakes Ln, Richmond TX 77469 |
| Mrs Beth G Speich | 1011 W County Rd, Jerseyville IL 62052 |
| Mr Merle Taylor | 296 N 1000 East Rd, Hammond IL 61929 |
| Mr Charles E Trotter | PO Box 222036, Carmel CA 93922 |
| Mrs Patricia V Trotter* | PO Box 222036, Carmel CA 93922 |
| Mr Darryl Vice | 22075 Skyview Dr, Palm Springs CA 92262 |
| Mrs Cindy Vogels | 3300 E Belleview Ave, Littleton CO 80121 |
| Ms Andrea Williams | 3008 Fincher Rd, Matthews NC 28104 |

* One or more breed assigned approved as provisional/permit by AKC

VARIETY GROUP JUDGES

TRI-STAR KC OF WILLIAMSON COUNTY TN (1)-SATURDAY

| | |
|------------------------------|--------------------|
| Mrs Cindy Vogels | Sporting Group |
| Mr Thomas L Kirstein | Hound Group |
| Mr Garry K Newton | Working Group |
| Mrs Patricia V Trotter | Terrier Group |
| Mrs Peggy Dillard Carr | Toy Group |
| Mr Charles E Trotter | Non-Sporting Group |
| Dr Sophia Kaluzniacki | Herding Group |
| Mr Merle Taylor | Best In Show |

OWNER-HANDLED VARIETY GROUPS-SATURDAY

| | |
|-----------------------------|----------------------------------|
| Mr Garry K Newton | Owner-Handled Sporting Group |
| Mrs Cindy Vogels | Owner-Handled Hound Group |
| Dr Sophia Kaluzniacki | Owner-Handled Working Group |
| Mr Thomas L Kirstein | Owner-Handled Terrier Group |
| Dr Sophia Kaluzniacki | Owner-Handled Toy Group |
| Mr Thomas L Kirstein | Owner-Handled Non-Sporting Group |
| Mr Darryl Vice | Owner-Handled Herding Group |
| Mr Charles E Trotter | Owner-Handled Best In Show |

TRI-STAR KC OF WILLIAMSON COUNTY TN (2)-SUNDAY

| | |
|------------------------------|--------------------|
| Mrs Beth G Speich | Sporting Group |
| Mr Garry K Newton | Hound Group |
| Mr Charles E Trotter | Working Group |
| Mrs Cindy Vogels | Terrier Group |
| Mr Merle Taylor..... | Toy Group |
| Mrs Peggy Dillard Carr | Non-Sporting Group |
| Mrs Patricia V Trotter..... | Herding Group |
| Dr Sophia Kaluzniacki..... | Best In Show |

OWNER-HANDLED VARIETY GROUPS-SUNDAY

| | |
|------------------------------|----------------------------------|
| Mr Charles E Trotter | Owner-Handled Sporting Group |
| Mr Charles E Trotter | Owner-Handled Hound Group |
| Mrs Cindy Vogels..... | Owner-Handled Working Group |
| Dr Sophia Kaluzniacki..... | Owner-Handled Terrier Group |
| Mr Garry K Newton..... | Owner-Handled Toy Group |
| Mr Merle Taylor..... | Owner-Handled Non-Sporting Group |
| Dr Sophia Kaluzniacki | Owner-Handled Herding Group |
| Mrs Patricia V Trotter | Owner-Handled Best In Show |

JUDGING ASSIGNMENTS

| SPORTING BREEDS | TRSR1-(SAT) | TRSR2-(SUN) |
|---------------------------------------|--------------|-------------|
| Brittany | C Vogels | B G Speich |
| Lagotti Romagnoli | C Vogels | B G Speich |
| Pointers | C Vogels | B G Speich |
| Pointers (German Shorthaired) | C Vogels | B G Speich |
| Pointers (German Wirehaired) | C Vogels | B G Speich |
| Retrievers (Chesapeake Bay) | C Vogels | B G Speich |
| Retrievers (Curly-Coated) | C Vogels | B G Speich |
| Retrievers (Flat-Coated) | C Vogels | B G Speich |
| Retrievers (Golden) | C Vogels | B G Speich |
| Retrievers (Labrador) | C Vogels | B G Speich |
| Retrievers (Nova Scotia Duck Tolling) | C Vogels | B G Speich |
| Setters (English) | C Vogels | B G Speich |
| Setters (Gordon) | C Vogels | B G Speich |
| Setters (Irish) | C Vogels | B G Speich |
| Setters (Irish Red And White) | C Vogels | B G Speich |
| Spaniels (American Water) | C Vogels | B G Speich |
| Spaniels (Boykin) | B G Speich | P V Trotter |
| Spaniels (Clumber) | B G Speich | P V Trotter |
| Spaniels (Cocker) Black | B G Speich | P V Trotter |
| Spaniels (Cocker) Ascob | B G Speich | P V Trotter |
| Spaniels (Cocker) Parti-Color | B G Speich | P V Trotter |
| Spaniels (English Cocker) | B G Speich | P V Trotter |
| Spaniels (English Springer) | B G Speich | P V Trotter |
| Spaniels (Field) | B G Speich | P V Trotter |
| Spaniels (Irish Water) | B G Speich | P V Trotter |
| Spaniels (Sussex) | B G Speich | P V Trotter |
| Spaniels (Welsh Springer) | B G Speich | P V Trotter |
| Spinoni Italiani | B G Speich | P V Trotter |
| Vizslas | B G Speich | P V Trotter |
| Weimaraners | B G Speich | P V Trotter |
| Wirehaired Pointing Griffons | B G Speich | P V Trotter |
| Wirehaired Vizslas | B G Speich | P V Trotter |
| HOUND BREEDS | TRSR1-(SAT) | TRSR2-(SUN) |
| Afghan Hounds | T L Kirstein | C E Trotter |
| American English Coonhounds | T L Kirstein | C E Trotter |
| American Foxhounds | T L Kirstein | C E Trotter |
| Basenjis | T L Kirstein | G K Newton |
| Basset Hounds | T L Kirstein | C E Trotter |
| Beagles (13 Inch) | T L Kirstein | G K Newton |
| Beagles (15 Inch) | T L Kirstein | G K Newton |
| Black & Tan Coonhounds | T L Kirstein | C E Trotter |

| | | |
|----------------------------------|-----------------------|--------------------|
| Bloodhounds | T L Kirstein | CE Trotter |
| Bluetick Coonhounds | T L Kirstein | CE Trotter |
| Borzoi | T L Kirstein | CE Trotter |
| Cirnechi dell'Etna | T L Kirstein | G K Newton |
| Dachshunds (Longhaired) | T L Kirstein(O) | G K Newton(O) |
| Dachshunds (Smooth) | T L Kirstein(O) | G K Newton(O) |
| Dachshunds (Wirehaired) | T L Kirstein(O) | G K Newton(O) |
| English Foxhounds | T L Kirstein | CE Trotter |
| Greyhounds | T L Kirstein | CE Trotter |
| Harriers | T L Kirstein | CE Trotter |
| Ibizan Hounds | T L Kirstein | CE Trotter |
| Irish Wolfhounds | T L Kirstein | CE Trotter |
| Norwegian Elkhounds | T L Kirstein | CE Trotter |
| Otterhounds | T L Kirstein | G K Newton |
| Petits Bassets Griffons Vendeens | T L Kirstein | CE Trotter |
| Pharaoh Hounds | T L Kirstein | G K Newton |
| Plotts | T L Kirstein | G K Newton |
| Portuguese Podengo Pequenos | T L Kirstein | P V Trotter |
| Redbone Coonhounds | T L Kirstein | G K Newton |
| Rhodesian Ridgebacks | | |
| Sweepstakes | A Williams | |
| Veteran Sweepstakes | A Williams | |
| Rhodesian Ridgebacks | T L Kirstein | G K Newton |
| Salukis | T L Kirstein | G K Newton |
| Scottish Deerhounds | T L Kirstein | CE Trotter |
| Sloughis | T L Kirstein | CE Trotter |
| Treeing Walker Coonhounds | T L Kirstein | CE Trotter |
| Whippets | T L Kirstein | G K Newton |
| WORKING BREEDS | TRSR1-(SAT) | TRSR2-(SUN) |
| Akitas | G K Newton | CE Trotter |
| Alaskan Malamutes | G K Newton | CE Trotter |
| Anatolian Shepherd Dogs | G K Newton | CE Trotter |
| Bernese Mountain Dogs | G K Newton | CE Trotter |
| Black Russian Terriers | G K Newton | CE Trotter |
| Boerboels | G K Newton | CE Trotter |
| Boxers | D Vice(O) | G K Newton(O) |
| Bullmastiffs | G K Newton | CE Trotter |
| Cane Corso | G K Newton | CE Trotter |
| Chinooks | G K Newton | CE Trotter |
| Doberman Pinschers | P V Trotter(O) | G K Newton(O) |
| Dogues de Bordeaux | G K Newton | CE Trotter |
| German Pinschers | G K Newton | CE Trotter |
| Giant Schnauzers | G K Newton | CE Trotter |
| Great Danes | G K Newton(O) | CE Trotter(O) |
| Great Pyrenees | G K Newton | CE Trotter |
| Greater Swiss Mountain Dogs | G K Newton | CE Trotter |
| Komondorok | G K Newton | CE Trotter |
| Kuvaszok | G K Newton | CE Trotter |
| Leonbergers | G K Newton | CE Trotter |
| Mastiffs | G K Newton | CE Trotter |
| Neapolitan Mastiffs | | |
| Sweepstakes | O Illescas | |
| Veteran Sweepstakes | O Illescas | |
| Neapolitan Mastiffs | P V Trotter | CE Trotter |
| | Specialty Show | |
| | Veteran Dog | |
| | Veteran Bitch | |
| Newfoundlands | G K Newton | CE Trotter |
| Portuguese Water Dogs | G K Newton | CE Trotter |
| Rottweilers | G K Newton | CE Trotter |
| Saint Bernards | G K Newton | CE Trotter |
| Samoyeds | G K Newton | CE Trotter |
| Siberian Huskies | G K Newton | CE Trotter |
| Standard Schnauzers | G K Newton | CE Trotter |
| Tibetan Mastiffs | G K Newton | CE Trotter |

(O) Open Classes divided - See Page 8

| TERRIER BREEDS | TRSR1-(SAT) | TRSR2-(SUN) |
|---------------------------------|--------------------|--------------------|
| Airedale Terriers | PV Trotter | C Vogels |
| American Hairless Terriers | PV Trotter | C Vogels |
| American Staffordshire Terriers | PV Trotter | C Vogels |
| Australian Terriers | PV Trotter | C Vogels |
| Bedlington Terriers | PV Trotter | C Vogels |
| Border Terriers | PV Trotter | C Vogels |
| Bull Terriers (Colored) | PV Trotter | C Vogels |
| Bull Terriers (White) | PV Trotter | C Vogels |
| Cairn Terriers | PV Trotter | C Vogels |
| Cesky Terriers | PV Trotter | C Vogels |
| Dandie Dinmont Terriers | PV Trotter | C Vogels |
| Fox Terriers (Smooth) | M Taylor | C Vogels |
| Fox Terriers (Wire) | M Taylor | C Vogels |
| Glen of Imaal Terriers | PV Trotter | C Vogels |
| Irish Terriers | PV Trotter | C Vogels |
| Kerry Blue Terriers | PV Trotter | C Vogels |
| Lakeland Terriers | PV Trotter | C Vogels |
| Manchester Terriers (Standard) | PV Trotter | C Vogels |
| Miniature Bull Terriers | PV Trotter | C Vogels |
| Miniature Schnauzers | PV Trotter | C Vogels |
| Norfolk Terriers | PV Trotter | C Vogels |
| Norwich Terriers | PV Trotter | C Vogels |
| Parson Russell Terriers | PV Trotter | C Vogels |
| Rat Terriers | PV Trotter | C Vogels |
| Russell Terriers | PV Trotter | C Vogels |
| Scottish Terriers | T L Kirstein | C Vogels |
| Sealyham Terriers | PV Trotter | C Vogels |
| Skye Terriers | PV Trotter | C Vogels |
| Soft Coated Wheaten Terriers | PV Trotter | C Vogels |
| Staffordshire Bull Terriers | PV Trotter | C Vogels |
| Welsh Terriers | PV Trotter | C Vogels |
| West Highland White Terriers | PV Trotter | C Vogels |

| TOY BREEDS | TRSR1-(SAT) | TRSR2-(SUN) |
|--------------------------------|--------------------|--------------------|
| Affenpinschers | C Vogels | M Taylor |
| Brussels Griffons | PV Trotter | M Taylor |
| Cavalier King Charles Spaniels | PV Trotter | M Taylor |
| Chihuahuas (Long Coat) | PV Trotter | M Taylor |
| Chihuahuas (Smooth Coat) | PV Trotter | M Taylor |
| Chinese Cresteds | CE Trotter | M Taylor |
| English Toy Spaniels (B & P C) | PD Carr | M Taylor |
| English Toy Spaniels (K C & R) | PD Carr | M Taylor |
| Havanese | PD Carr | M Taylor |
| Italian Greyhounds | PD Carr | M Taylor |
| Japanese Chin | PD Carr | M Taylor |
| Maltese | PD Carr | M Taylor |
| Manchester Terriers (Toy) | PV Trotter | D Vice |
| Miniature Pinschers | PV Trotter | D Vice |
| Papillons | PD Carr | D Vice |
| Pekingese | PD Carr | D Vice |
| Pomeranians | PD Carr | D Vice |
| Poodles (Toy) | PD Carr | D Vice |
| Pugs | PD Carr | D Vice |
| Shih Tzu | PD Carr | D Vice |
| Silky Terriers | PD Carr | D Vice |
| Toy Fox Terriers | PV Trotter | D Vice |
| Yorkshire Terriers | PV Trotter | D Vice |

| NON-SPORTING BREEDS | TRSR1-(SAT) | TRSR2-(SUN) |
|----------------------------|--------------------|--------------------|
| American Eskimo Dogs | CE Trotter | D Vice |
| Bichons Frises | CE Trotter | PD Carr |
| Boston Terriers | CE Trotter(O) | PD Carr(O) |
| Bulldogs | D Vice | PD Carr |
| Chinese Shar-Pei | CE Trotter | PD Carr |
| Chow Chows | CE Trotter | D Vice |

(O) Open Classes divided - See Page 8

| | | |
|----------------------|------------|--------------|
| Coton de Tulear | CE Trotter | D Vice |
| Dalmatians | CE Trotter | D Vice |
| Finnish Spitz | CE Trotter | P D Carr |
| French Bulldogs | CE Trotter | P D Carr |
| Keeshonden | CE Trotter | P D Carr |
| Lhasa Apos | D Vice | P D Carr |
| Lowchen | D Vice | P V Trotter* |
| Norwegian Lundehunds | D Vice | P V Trotter |
| Poodles (Miniature) | D Vice | P D Carr |
| Poodles (Standard) | D Vice | P D Carr |
| Schipperkes | D Vice | P D Carr |
| Shiba Inu | D Vice | P D Carr |
| Tibetan Spaniels | D Vice | P V Trotter |
| Tibetan Terriers | D Vice | P V Trotter |
| Xoloitzcuintli | D Vice | P V Trotter* |

| HERDING BREEDS | TRSR1-(SAT) | TRSR2-(SUN) |
|------------------------------|-----------------------|--------------------|
| Australian Cattle Dogs | M Taylor | S Kaluzniacki |
| Australian Shepherds | M Taylor(O) | S Kaluzniacki(O) |
| Bearded Collies | M Taylor | S Kaluzniacki |
| Beaucerons | M Taylor | S Kaluzniacki |
| Belgian Malinois | M Taylor | S Kaluzniacki |
| Belgian Sheepdogs | M Taylor | S Kaluzniacki |
| Belgian Tervuren | M Taylor | S Kaluzniacki |
| Bergamasco Sheepdogs | M Taylor | S Kaluzniacki |
| Berger Picards | M Taylor | S Kaluzniacki |
| Border Collies | M Taylor | S Kaluzniacki |
| Bouvier des Flandres | M Taylor | S Kaluzniacki |
| Briards | M Taylor | S Kaluzniacki |
| Canaan Dogs | M Taylor | S Kaluzniacki |
| Cardigan Welsh Corgis | M Taylor | S Kaluzniacki |
| Collies (Rough) | S Kaluzniacki(O) | P V Trotter(O) |
| Collies (Smooth) | S Kaluzniacki | P V Trotter |
| Entlebucher Mountain Dogs | S Kaluzniacki | P V Trotter |
| Finnish Lapphunds | S Kaluzniacki | P V Trotter |
| German Shepherd Dogs | S Kaluzniacki | P V Trotter |
| Icelandic Sheepdogs | S Kaluzniacki | P V Trotter |
| Miniature American Shepherds | S Kaluzniacki | P V Trotter |
| Norwegian Buhunds | S Kaluzniacki | P V Trotter |
| Old English Sheepdogs | S Kaluzniacki | P V Trotter |
| Pembroke Welsh Corgis | S Kaluzniacki | P V Trotter |
| Polish Lowland Sheepdogs | S Kaluzniacki | P V Trotter |
| Pulik | | |
| Sweepstakes | B G Speich | |
| Veteran Sweepstakes | B G Speich | |
| Pulik | M Taylor | CE Trotter |
| | Specialty Show | |
| | Veteran Dog | |
| | Veteran Bitch | |
| Pumik | S Kaluzniacki | P V Trotter |
| Pyrenean Shepherds | S Kaluzniacki | P V Trotter |
| Shetland Sheepdogs | S Kaluzniacki(O) | P V Trotter(O) |
| Spanish Water Dogs | S Kaluzniacki | P V Trotter |
| Swedish Vallhunds | S Kaluzniacki | P V Trotter |

| MISC CLASS | TRSR1-(SAT) | TRSR2-(SUN) |
|--|--------------------|--------------------|
| Azawakh, Barbet, Belgian Laekenois, Dogo Argentino, Dutch Shepherds, Grand Basset Griffon Vendeens, Nederlandse Kooikerhondjes, Norrbottenspets, Peruvian Inca Orchids, Portuguese Podengo. | | |

There will be Puppy, Bred-By-Exhibitor and Open Classes for each of the Miscellaneous Breeds in each sex.

| JUNIOR SHOWMANSHIP | TRSR1-(SAT) | TRSR2-(SUN) |
|---------------------------|--------------------|--------------------|
| | T L Kirstein | S Kaluzniacki |
| | M Taylor | S Kaluzniacki |

(O) Open Classes divided - See Page 8

ATTENTION EXHIBITORS

The Show Site will be available to exhibitors at 1:00 pm to 6:00 pm, Thursday, October 12, 2017; 6:30 am to 11:00 pm, Friday, October 13, 2017; 6:30 am to 11:00 pm, Saturday, October 14, 2017 and 6:30 am to Best In Show Sunday, October 15, 2017. All vending items, crates & dogs must be removed from the show site immediately following Best in Show judging.

* EXHIBITORS PLEASE NOTE *

- No space for unentered dogs.
- Admission Fee for spectators is **\$5.00** for a couple or a single person. In lieu of cash, spectators may bring 5 cans of food which will be donated to a local food bank. All Senior Citizens & children are **FREE**.
- Dogs will not be allowed to remain in the building overnight, but there will be an additional building for dogs that need to be left overnight. The building will be locked at 11:00 pm & opened at 6:30 am. Please make sure that you have made all arrangements for your animals before the building is locked.
- Practicing in the ring is prohibited.
- Wilson County Exposition Center Rules. Anyone caught breaking this rule will have an Event Committee hearing.
 1. NO EX-PENS inside the Exhibit Hall. Please use plastic under all outdoor Ex-Pens. All ex-pen areas must be kept clean.
 2. No dogs will be allowed in restrooms.
 3. No washing of dog or dog pans in restrooms.
 4. No dogs allowed in concourse or vicinity of open concessions.
 5. No baby strollers or children playpens will be allowed in the buildings.
- Cars blocking exits or no parking areas will be towed/ticketed by local police or fairground security.
- **Dogs left in cars or crates will be removed, if the animal appears to be in distress!** WAIVER OF RIGHTS: All persons attending these dog shows hereby waive any claim for damages against the Tri-Star Kennel Club of Williamson County, Tennessee or its members in the event a motor vehicle must be entered to rescue a dog from overheating or suffocating due to improper ventilation.
- No entry shall be refunded for bitches that come in season after the closing date of these shows.
- Only Best in Show, Groups & Best Junior Handler trophies will be presented in the ring. All other winners will be given a card. The owner or agent may claim the trophy at the trophy table. All trophies must be claimed the day of the show, none will be mailed. The club reserves the right to substitute any trophy with one of equal value.
- No gasoline or gas generators will be allowed within 100 feet of the show buildings on the fairgrounds.
- Parents bringing children - be responsible - keep an eye on your children.
- Please pick up after your dogs & yourself so we may continue to use the new facility.
- Exhibitors Note: Please notify Superintendent of any change of address.
- Soft-sided crates will not be allowed in the building. Please stack all crates. Regular crates are permitted at ringside, but must be moved immediately after the breed is completed.
- Tape must be used on all electrical cords.
- Grooming in designated areas ONLY! There will be a poster indicating where your reserved grooming is located.

The Tri-Star Kennel Club does not agree to arbitrate claims as set forth on the Official AKC entry form for these events.

A Judge requesting the use of a ramp must give notice to the show superintendent/show secretary prior to judging. The entire entry in a breed is to be examined in the same manner (ground, table, or ramp). Ramps can be used in emergency situation to judge any breed. In an emergency situation an exhibitor has the option of withdrawing their entry and receiving a refund.

The following breeds may be judged on the ground or on a ramp: Lagotto Romagnolo, American Water Spaniels, Clumber Spaniels, English Springer Spaniels, Field Spaniels, Welsh Springer Spaniels, Cirneco dell'Etna, Irish Terriers, Kerry Blue Terriers, Soft Coated Wheaten Terriers, Staffordshire Bull Terriers, Finnish Spitz, Keeshonden, Finnish Lapphunds, Norwegian Buhunds, Polish Lowland Sheepdogs, Spanish Water Dogs and Norrbottenspets (Misc).

The following breeds may be judged on the ground, a ramp, or on a table: Boykin Spaniels and Whippets.

The following breeds must be judged on a ramp through all levels of conformation competition: Sussex Spaniels, Basset Hounds, Bulldogs, Chinese Shar-Pei and Chow Chows.

NEW EXHIBITOR BRIEFING on Saturday. Check Judging Program for time & location.

A Recording Fee of 50 cents for each dog and an AKC Event Service Fee of \$3.00 will be required for each recordable single entry class at any Licensed or Member Club Show or Obedience Trial. (American Kennel Club Rule, Chapter 11, Section 2). An AKC Recording Fee of \$3.50 1st Entry & \$3.00 additional entry of same dog will be required for each entry in Rally. (American Kennel Club Rally Regulation, Chapter 1, Section 3) These Fees are paid to the American Kennel Club.

CANADIAN EXHIBITORS MUST SUBMIT ENTRIES WITH CHECKS DRAWN ON U.S. ACCOUNTS OR WITH INTERNATIONAL MONEY ORDERS IN U.S. FUNDS.

There will be no refund for duplicate entries.

Dogs need be present only for scheduled judging and will be released if not needed for further judging.

Dogs allowed in rings during judging only.

Dogs must be ready for judging. Neither the club nor its Superintendents will be responsible or obligated to furnish any service for notifying exhibitors or their agents of Breed or Class Judging. Judges need not wait for any dog holding up a class. **Owners or agents alone are responsible for the presence of their dogs in the judging rings.**

The Club reserves the right to substitute a prize of equal or greater value.

All trophies must be claimed the day of the show - None will be mailed.

All checks issued as prizes are the sole responsibility of the recipient. Lost, stolen and/or misplaced checks will not be replaced. Checks are valid for 90 days. The Superintendent is not able to cash checks.

RETURNED CHECKS/DECLINED CREDIT/DEBIT CARDS do not constitute a valid entry fee. Fees must be paid in guaranteed funds. Checks will not be accepted. The Superintendent will add a fee for completing the transaction and/or reprocessing the entries. Repeated occurrences from the same exhibitors may result in their being put on a CASH ONLY basis.

Entry Fee will not be refunded in the event that a dog is absent, disqualified, excused by Veterinarian or judge or barred from competition by action of the Show Committee.

Exhibitors should follow their veterinarian's recommendation to assure their dogs are free of internal and external parasites, any communicable diseases and have appropriate vaccinations.

No entry fees will be refunded if the Show cannot open or be completed by reason of riots, civil disturbances, fire, extreme and/or dangerous weather conditions, an Act of God, public emergency, act of a public enemy, strikes or any other cause beyond the control of the Club or the Superintendent.

The show giving Club, the Show Superintendent, their agents, employees, etc, assume no responsibility for any loss, damage or injury sustained by exhibitors, handlers, or to any of their dogs or property and further assume no responsibility for injury to children.

No entry shall be made and no entry shall be accepted which specifies any condition as to its acceptance. Entries will not be accepted without fees, signatures or the "Agreement" on the reverse side of the Official AKC Entry Form.

Changes, additions or corrections to entry forms must be received in writing prior to close of entries. Those received by telephone are not acceptable.

Refunds of \$3.00 & less will not be issued due to the costs of processing.

An administrative fee of \$2.00 will be charged for all cancellations or changes made prior to closing of entries.

EXHIBITORS NOTE: Please notify Superintendent of any change of address.

FAX/EMAIL ENTRIES AND PAPER ENTRIES WITH CREDIT CARD ARE NOT ACCEPTABLE METHODS FOR ENTRIES AND WILL NOT BE PROCESSED. **Online Entries and Checks by Mail are not affected by this change.** If mailing be sure to have the entry with check enclosed arrive prior to the closing date of the show. Please note all entries received via fax or email and/or paper entries with credit card information will be shredded/deleted immediately upon delivery without processing. With credit card security and identity theft concerns we are implementing this change to protect your information from potential abuse. Entry forms are occasionally viewed by others outside of the staff of the Superintendent. We will always be happy to accept entries with payment by check at any of our shows. Stop by and say hello.

Jack Onofrio Dog Shows Telephone Entry Service phone number (405) 427-0405 or toll free (888) 421-0405: This is for Telephone Entry Service ONLY. For Mastercard/Discover/Visa/American Express cardholders. A \$4.75 charge will be added to each entry for use of this service. Mon, Tues, Thurs & Fri 8:00 am to 4:30 pm; Wed 8:00 am to 12:00 noon.

Onofrio Online Entry at www.onofrio.com for entries made with Mastercard/Discover/Visa/American Express. A \$2.95 charge will be added to each entry for use of this service.

Special Delivery & Overnight Delivery Mail Address: 3401 NE 23rd St, Oklahoma City, Oklahoma 73121-2447
FOR SPECIAL & OVERNIGHT DELIVERY MAIL ONLY!

TRI-STAR KENNEL CLUB OF WILLIAMSON COUNTY TN VENDING INFORMATION

Wilson County Exposition Center • 940 East Baddour Prkwy, Lebanon TN
October 13-15, 2017

For more information contact:

Carol Clouse, Vendor Chairman • 120 Lakewood Dr, La Vergne TN 37086
(615) 584-0563 • dogworld123@comcast.net

Description of Product/Service/Space Size needed

Our show will be located indoors on a concrete floor with climate control. We have moved into additional buildings & have nearly doubled our square footage for the show. Vendors will have electricity available to them & each vendor will receive one reserved parking pass with their reservation. Parking spaces are available on a first come, first serve basis.

Reservations must be received by **September 27, 2017**

Vendor spaces available (Sizes may vary slightly):

10' x 10' • \$150.00 for three days

10' x 20' • \$250.00 for three days

10' x 30' • \$300.00 for three days

10' x 40' • \$350.00 for three days

Vendors are responsible for any loss or damage to their products & booth while vending at the show. The Club & show site will not be held liable.

VENDING APPLICATION

NAME OF BUSINESS: _____

CONTACT NUMBER: _____

PHONE NUMBER: _____

ALT PHONE NUMBER: _____

E-MAIL: _____

SPACE SIZE NEEDED: _____

AMOUNT ENCLOSED: _____

DESCRIPTION OF PRODUCTS/SERVICES: _____

PLEASE RETURN APPLICATION WITH CHECK MADE PAYABLE TO:

Tri-Star Kennel Club of Williamson County TN

& Mail to: Carol Clouse • Vendor Chairperson

120 Lakewood Dr, La Vergne TN 37086

(615) 584-0563 • dogworld123@comcast.net

RESERVED GROOMING SPACE

Tri Star Kennel Club of Williamson County TN will once again provide "Reserved Grooming". Grooming prices for the entire 3 day weekend and the cost are listed below. There is "Free Grooming" spaces, but there will be no electric outlets. If you use an electric outlet, you will be charged per 10 foot space you are using ... THERE WILL BE NO EXCEPTIONS!!!

Deadline: September 27, 2017

For more information contact:

Bryan McMillian

107 Sunny Meade Dr, Mt Juliet TN 37112

(615) 390-5627 • bam107@yahoo.com

RESERVED GROOMING REQUEST

NAME: _____

ADDRESS: _____

PHONE NUMBER: _____

BREED: _____

E-MAIL: _____

MAIN BUILDING (SHOW ARENA) _____ @ \$35.00 per space for entire 3 days

TURNER BUILDING _____ @ \$45.00 per space for entire 3 days

TOTAL AMOUNT ENCLOSED \$ _____

PLEASE MAKE CHECK PAYABLE TO:

TRI-STAR KENNEL CLUB OF WILLIAMSON COUNTY TN

RETURN FORM TO:

Bryan McMillian

107 Sunny Meade Dr, Mt Juliet TN 37112

The grooming will be inside. Everything must be swept and cleaned before leaving the show grounds. THERE WILL BE NO FREE ELECTRICITY!!!

Please Note: Main Building (Show Arena) - Dogs cannot stay overnight. Turner Building - Dogs can stay overnight.

If outlets are used, exhibitor will be charged. Exhibitors are responsible for keeping their grooming area clean & setting up in allotted space. This will be strictly enforced by the Show Committee.

If an exhibitor has not paid in full by 9:00 am Sunday morning, October 15, 2017 they will be requested to appear before an event committee hearing.



American Kennel Club Registered Handlers Program
and Purina ProPlan®

**In Conjunction with the Tri Star Kennel Club of Williamson County
Present**

“Junior Handler Clinic with the Professionals”

**Lebanon, Tennessee
Saturday, Oct 14, 2017**

**Moderated by AKC Registered Handler Program Coordinators,
Assisted by AKC Registered Handlers.**

You are the future of our sport

All current and future Junior Showmanship participants are invited to attend our FREE clinic. This is your opportunity to receive *individual instruction* (with your dog) from AKC registered professional handlers, to better enable you to present your dog in the show ring.

SATURDAY

BEST IN SHOW & VARIETY GROUP PRIZES

FOR BEST IN SHOW

COUNTRY MUSIC GUITAR

Offered by George Guhn

BABY BLUE, RED & WHITE ROSETTE

Offered by the Tri-Star Kennel Club of Williamson County, Tennessee

FOR RESERVE BEST IN SHOW

BLACK & GOLD ROSETTE

Offered by the Tri-Star Kennel Club of Williamson County, Tennessee

FOR BEST OWNER-HANDLED IN SHOW

POLO SHIRT AUTOGRAPHED BY COUNTRY MUSIC STARS

Offered by Thomas, Tondalea' & Peggy Wright, Tomjo Kennels

ROSETTE

Offered by the Tri-Star Kennel Club of Williamson County, Tennessee

FOR RESERVE BEST OWNER-HANDLED IN SHOW

ROSETTE

Offered by the Tri-Star Kennel Club of Williamson County, Tennessee

FOR FIRST IN EACH REGULAR VARIETY GROUP

HAND HELD GUITAR TROPHY

Sporting Group

Offered by Helene Guida, Pinewood Kennels

Hound Group

Offered by Linda Winford & Kathy Lyons, Southridge Kennels

Working Group

Offered by Cheryl Green, Al'Cher Dobermans

Terrier Group

Offered by Claudia Seaburg

Toy Group

Offered by Dick Dickerson

Non-Sporting Group

Offered by the Music City Bulldog Club

Herding Group

Offered by Dick Dickerson

FOR FIRST, SECOND, THIRD & FOURTH IN EACH REGULAR VARIETY GROUP

ROSETTE

Offered by the Tri-Star Kennel Club of Williamson County, Tennessee

FOR FIRST IN EACH OWNER-HANDLED VARIETY GROUP

EMBROIDERED TOWEL

Sporting Group

Offered by Sally Sklar

Hound Group

Offered by Paul Hines

Working Group

Offered by Tim McCormack

Terrier Group

Offered by Anne Kieffer

Toy Group

Offered by Dick Dickerson

Non-Sporting Group

Offered by Sandra Edson

Herding Group

Offered by Claudia Seaberg

**FOR FIRST, SECOND, THIRD & FOURTH IN
EACH OWNER-HANDLED VARIETY GROUP**

ROSETTE

Offered by the Tri-Star Kennel Club of Williamson County, Tennessee

BREED PRIZES

HOUND BREEDS

BASENJIS

BEST OF BREED - Food Bowl filled with Treats offered by Thomas, Tondalea' & Peggy Wright, Tomjo Kennels

BASSET HOUNDS

BEST OF BREED - Ceramic Treat Canister offered by Bobbie Wilhoite

DACHSHUNDS (LONGHAIRD)

THE CUMBERLAND VALLEY DACHSHUND CLUB SUPPORTS THE ENTRY OF ITS BREED AT THIS SHOW.

Best of Variety
Best of Opposite Sex to Best of Variety
Winners Dog/Winners Bitch
THREE STREAMER ROSETTE

Offered by the Tri-Star Kennel Club of Williamson County, Tennessee

DACHSHUNDS (SMOOTH)

THE CUMBERLAND VALLEY DACHSHUND CLUB SUPPORTS THE ENTRY OF ITS BREED AT THIS SHOW.

Best of Variety
Best of Opposite Sex to Best of Variety
Winners Dog/Winners Bitch
THREE STREAMER ROSETTE

Offered by the Tri-Star Kennel Club of Williamson County, Tennessee

DACHSHUNDS (WIREHAIRD)

THE CUMBERLAND VALLEY DACHSHUND CLUB SUPPORTS THE ENTRY OF ITS BREED AT THIS SHOW.

Best of Variety
Best of Opposite Sex to Best of Variety
Winners Dog/Winners Bitch
THREE STREAMER ROSETTE

Offered by the Tri-Star Kennel Club of Williamson County, Tennessee

BEST OF WINNERS - Silver Plated Bowl offered by Bobbie Wilhoite

HARRIERS

BEST OF BREED - Food Bowl filled with Treats offered by Thomas, Tondalea' & Peggy Wright, Tomjo Kennels

IRISH WOLFHOUNDS

BEST OF BREED - Gift Basket (Value \$10.00) offered by Chuck & Laura Dunn, Dalwhinnie Farm PRTs, Portland TN

RHODESIAN RIDGEBACKS

THE RHODESIAN RIDGEBACK CLUB OF THE UNITED STATES SUPPORTS THE ENTRY OF ITS BREED AT THIS SHOW.

SWEEPSTAKES

REQUIREMENTS & CLASSIFICATION

Handlers may only enter dogs they own. No champions of record may enter. Major pointed dogs ARE allowed to enter. Dogs shown in Sweepstakes must also be entered in one of the regular classes at the regular entry fee and on the regular entry form. Indicate your Sweepstakes Class with the age division in the space provided for "Additional Class."

The following classes will be provided for both dogs and bitches.

Puppy, 6 Mos & Under 9 Mos • Puppy, 9 Mos & Under 12 Mos
Junior, 12 Mos & Under 15 Mos • Junior, 15 Mos & Under 18 Mos

DIVISION OF ENTRY MONEY AS PRIZES

35% of total entry fees will be retained by the Club for expenses. The remaining 65% will be divided as follows: 1st - 40% • 2nd - 30% • 3rd - 20% • 4th - 10%

SWEEPSTAKES PRIZES

Best in Sweepstakes
Best of Opposite Sex to Best in Sweepstakes

ROSETTE

Offered by Kathleen Lyons, Linda Winford & Elizabeth Mask

BEST IN SWEEPSTAKES - Breed Related Trophy (Value \$25.00) offered by Kathleen Lyons, Linda Winford & Elizabeth Mask

BEST OF OPPOSITE SEX TO BEST IN SWEEPSTAKES - Breed Related Trophy (Value \$25.00) offered by Kathleen Lyons, Linda Winford & Elizabeth Mask

VETERAN SWEEPSTAKES

REQUIREMENTS & CLASSIFICATION

Dogs shown in Veteran Sweepstakes need not be entered in one of the regular classes or at the regular entry fee. Indicate your Veteran Sweepstakes Class with the age division in the space provided.

The following classes will be provided for both dogs and bitches.

Veteran, 7 Yrs & Under 9 Yrs • Veteran, 9 Yrs & Older

DIVISION OF ENTRY MONEY AS PRIZES

35% of total entry fees will be retained by the Club for expenses. The remaining 65% will be divided as follows: 1st - 40% • 2nd - 30% • 3rd - 20% • 4th - 10%

VETERAN SWEEPSTAKES PRIZE

Best in Veteran Sweepstakes
Best of Opposite Sex to Best in Veteran Sweepstakes

ROSETTE

Offered by Kathleen Lyons, Linda Winford & Elizabeth Mask

BEST IN VETERAN SWEEPSTAKES - Breed Related Trophy (Value \$25.00) offered by Kathleen Lyons, Linda Winford & Elizabeth Mask

BEST OF OPPOSITE SEX TO BEST IN VETERAN SWEEPSTAKES - Breed Related Trophy (Value \$25.00) offered by Kathleen Lyons, Linda Winford & Elizabeth Mask

REGULAR CLASS PRIZES

Best of Breed
Best of Opposite Sex to Best of Breed
Winners Dog/Winners Bitch

THREE STREAMER ROSETTE

Offered by the Tri-Star Kennel Club of Williamson County, Tennessee

Best of Winners
Best Veteran
First in Each Class

ROSETTE

Offered by Kathleen Lyons, Linda Winford & Elizabeth Mask

The RRCU Bronze Club Medallion will be awarded to the Best of Breed winner, providing that the number of dogs in competition is either: a) 10 Ridgebacks or, b) the combined total number of dogs required in competition, according to the AKC, for a 3-point major in both sexes, in that region, whichever is greater.

The following prizes will be an Etched Glass Carafe (Minimum Value \$25.00) offered by Kathleen Lyons, Linda Winford & Elizabeth Mask

BEST OF BREED

BEST OF WINNERS

BEST OF OPPOSITE SEX TO BEST OF BREED

WINNERS DOG

WINNERS BITCH

BEST VETERAN

WORKING BREEDS

BOXERS

THE EAST TENNESSEE BOXER CLUB SUPPORTS THE ENTRY OF ITS BREED AT THIS SHOW.

Best of Breed
Best of Opposite Sex to Best of Breed
Winners Dog/Winners Bitch

THREE STREAMER ROSETTE

Offered by the Tri-Star Kennel Club of Williamson County, Tennessee

The following prizes will be a Deluxe Treat & Toy Basket offered by the East Tennessee Boxer Club.

BEST OF BREED
BEST OF OPPOSITE SEX TO BEST OF BREED
WINNERS DOG
WINNERS BITCH

DOBERMAN PINCHERS

THE DOBERMAN PINSCHER CLUB OF NASHVILLE SUPPORTS THE ENTRY OF ITS BREED AT THIS SHOW.

Best of Breed
Best of Opposite Sex to Best of Breed
Winners Dog/Winners Bitch

THREE STREAMER ROSETTE

Offered by the Tri-Star Kennel Club of Williamson County, Tennessee

The following prizes are offered by the Doberman Pinscher Club of Nashville.

BEST OF BREED - Cooler
BEST OF OPPOSITE SEX TO BEST OF BREED - Cooler
WINNERS DOG - Small Dog Gift Basket/Bag (Value \$5.00)
WINNERS BITCH - Small Dog Gift Basket/Bag (Value \$5.00)

NEAPOLITAN MASTIFFS

DESIGNATED SPECIALTY

THE UNITED STATES NEAPOLITAN MASTIFF CLUB CONSIDERS THE CLASSES AT THIS SHOW AS ITS SPECIALTY SHOW.

OFFICERS

Gonnie SchafferPresident
Rachel Hosking.....Vice President
Michael McDonald.....Treasurer
Alaina PierretSecretary
838 Old Spanish Rd, Opelousas LA 70570
Jessica GibbonsShow Chairman
384 Texas Palmyra Hwy, Hawley PA 18428

BOARD OF DIRECTORS

Adrian Bueno • Cassandra Boczar • Sherry Deans
Jessica Gibbons • John Grimes • Aaron Lozano • Troy Stroud

SWEEPSTAKES

REQUIREMENTS & CLASSIFICATION

Dogs shown in Sweepstakes must also be entered in one of the regular classes at the regular entry fee and on the regular entry form. Indicate your Sweepstakes Class with the age division in the space provided for "Additional Class."

The following classes will be provided for both dogs and bitches.

Puppy, 6 Mos & Under 9 Mos • Puppy, 9 Mos & Under 12 Mos
Junior, 12 Mos & Under 15 Mos • Junior, 15 Mos & Under 18 Mos

DIVISION OF ENTRY MONEY AS PRIZES

35% of total entry fees will be retained by the Club for expenses. The remaining 65% will be divided as follows: 1st - 40% • 2nd - 30% • 3rd - 20% • 4th - 10%

SWEEPSTAKES PRIZES

Best in Sweepstakes
Best of Opposite Sex to Best in Sweepstakes
First, Second, Third & Fourth in Each Class

ROSETTE

Offered by the United States Neapolitan Mastiff Club

BEST IN SWEEPSTAKES - Primo Pad offered by Sherry Deans, Sherwood Mastiffs
BEST OF OPPOSITE SEX TO BEST IN SWEEPSTAKES - Primo Pad offered by Jorge & Mandy Flores
FIRST, SECOND, THIRD & FOURTH IN EACH CLASS - Embroidered Crate Pad
PUPPY DOG CLASS (6 Mos & Under 9 Mos) - Offered by Ciaran & Laura McCloskey
PUPPY DOG CLASS (9 Mos & Under 12 Mos) - Offered by Mary & Brian Ham, Redbarn Mastiffs
JUNIOR DOG CLASS (12 Mos & Under 15 Mos) - Offered by Susan B Schramm
JUNIOR DOG CLASS (15 Mos & Under 18 Mos) - Offered by George Small & Remo Coppola, Gothic Mastini
PUPPY BITCH CLASS (6 Mos & Under 9 Mos) - Offered by Ciaran & Laura McCloskey
PUPPY BITCH CLASS (9 Mos & Under 12 Mos) - Offered by Carlos Munoz
JUNIOR BITCH CLASS (12 Mos & Under 15 Mos) - Offered by Sherry Deans, Sherwood Mastiffs
JUNIOR BITCH CLASS (15 Mos & Under 18 Mos) - Offered by Sherry Deans, Sherwood Mastiffs

VETERAN SWEEPSTAKES

REQUIREMENTS & CLASSIFICATION

Dogs shown in Veteran Sweepstakes need not be entered in one of the regular classes or at the regular entry fee. Indicate your Veteran Sweepstakes Class with the age division in the space provided.

The following classes will be provided for both dogs and bitches.

Veteran, 7 Yrs & Older

DIVISION OF ENTRY MONEY AS PRIZES

35% of total entry fees will be retained by the Club for expenses. The remaining 65% will be divided as follows: 1st - 40% • 2nd - 30% • 3rd - 20% • 4th - 10%

VETERAN SWEEPSTAKES PRIZE

Best in Veteran Sweepstakes
Best of Opposite Sex to Best in Veteran Sweepstakes

ROSETTE

Offered by the United States Neapolitan Mastiff Club

BEST IN VETERAN SWEEPSTAKES - Embroidered Crate Pad offered by Joni Greenlaw Doten, Ledgewood Mastini
BEST OF OPPOSITE SEX TO BEST IN VETERAN SWEEPSTAKES - Embroidered Crate Pad offered by Isiah Massenburg, Over the Bridge Mastinos

**THERE WILL BE COMPETITION FOR
BEST PUPPY IN PUPPY CLASSES, BEST BRED-BY-EXHIBITOR & BEST VETERAN**

REGULAR CLASS PRIZES

Best of Breed
Best of Wnners
Best of Opposite Sex to Best of Breed
Select Dog/Select Bitch
Winners Dog/Winners Bitch
Reserve Winners Dog/Reserve Winners Bitch
Best Veteran
First in Each Regular Class

ROSETTE

Offered by the United States Neapolitan Mastiff Club

Unless otherwise indicated, the following prizes will be Prize Bucket.

BEST OF BREED - Rolling Cooler & Accessories offered by John Seibel & Stacey Johnson, Double Trouble Mastino

BEST OF WINNERS - Cooler & Accessories offered by Sherry Subler, New Moon Neapolitans

BEST OF OPPOSITE SEX TO BEST OF BREED - Rolling Cooler & Accessories offered by Tyson Powell, Powerhouse Mastini

SELECT DOG - Offered by Dan Renfrow, Shoestring Acres

SELECT BITCH - Offered by Dan Renfrow, Shoestring Acres

WINNERS DOG - Offered by Cassandra Boczar, Il Drago Kennels

RESERVE WINNERS DOG - Offered by Ciaran & Laura McCloskey

WINNERS BITCH - Offered by Suzanne Storms

RESERVE WINNERS BITCH - Offered by Ciaran & Laura McCloskey

BEST PUPPY IN PUPPY CLASSES - Cooler & Accessories offered by Chris & Shanna Jones, Knuckelheads Neos

BEST BRED-BY-EXHIBITOR - Cooler & Accessories offered by Alaina & Neal Pierret, CowLane

BEST VETERAN - Wooden Mastino Plaque offered by the United States Neapolitan Mastiff Club

VETERAN DOG CLASS, 1st - Cooler & Accessories offered by Christine Pederson Harper, Heritage Mastiffs

VETERAN BITCH CLASS, 1st - Cooler & Accessories offered by a Supporter of the USNMC

AWARDS OF MERIT

The judge may, at his/her discretion, recall into the ring up to four dogs/bitches to receive a Rosette offered by the United States Neapolitan Mastiff Club & Prize Bucket offered by Jessica Gibbons, Stacey Turgeon & Rufio Ricardo. These Awards are reserved for those quality animals the judge feels are worthy of final consideration for Best of Breed.

TERRIER BREEDS

PARSON RUSSELL TERRIERS

The following prizes are offered by Chuck & Laura Dunn, Dalwhinnie Farm PRTs, Portland TN.

BEST OF BREED - Gift Basket (Value \$10.00)

BEST OF OPPOSITE SEX TO BEST OF BREED - Gift Basket (Value \$10.00)

WINNERS DOG - Dog Toy

WINNER BITCH - Dog Toy

TOY BREEDS

CHINESE CRESTEDS

THE CHINESE CRESTED CLUB OF NASHVILLE SUPPORTS THE ENTRY OF ITS BREED AT THIS SHOW.

Best of Breed

Best of Opposite Sex to Best of Breed

Winners Dog/Winners Bitch

THREE STREAMER ROSETTE

Offered by the Tri-Star Kennel Club of Williamson County, Tennessee

HAVANESE

THE HAVANESE CLUB OF AMERICA SUPPORTS THE ENTRY OF ITS BREED AT THIS SHOW.

Best of Breed

Best of Opposite Sex to Best of Breed

Winners Dog/Winners Bitch

THREE STREAMER ROSETTE

Offered by the Tri-Star Kennel Club of Williamson County, Tennessee

TOY FOX TERRIERS

THE AMERICAN TOY FOX TERRIER CLUB SUPPORTS THE ENTRY OF ITS BREED AT THIS SHOW.

Best of Breed
Best of Opposite Sex to Best of Breed
Winners Dog/Winners Bitch
THREE STREAMER ROSETTE

Offered by the Tri-Star Kennel Club of Williamson County, Tennessee

BEST OF BREED - \$100.00 offered by FritzFox Toy Fox Terriers
BEST OF OPPOSITE SEX TO BEST OF BREED - \$75.00 offered by William McAllister
SELECT DOG - \$50.00 offered by Ed & Carol Fernandes, Jamboree Toy Fox Terriers
SELECT BITCH - \$50.00 offered by Kim Rawls, Flair Toy Fox Terriers
WINNERS DOG - \$25.00 offered by Anne Kieffere, FritzFox Toy Fox Terriers
WINNERS BITCH - \$25.00 offered by Mary Redenbach
BEST OWNER-HANDLED - \$50.00 offered by Sally Sklar

NON-SPORTING BREEDS

BULLDOGS

THE MUSIC CITY BULLDOG CLUB SUPPORTS THE ENTRY OF ITS BREED AT THIS SHOW.

Best of Breed
Best of Opposite Sex to Best of Breed
Winners Dog/Winners Bitch
THREE STREAMER ROSETTE

Offered by the Tri-Star Kennel Club of Williamson County, Tennessee

The following prizes are offered by the Music City Bulldog Club.

BEST OF BREED - Hanging Garment Bag
BEST OF WINNERS - Bulldog Bank
BEST OF OPPOSITE SEX TO BEST OF BREED - Bulldog Plaque
WINNERS DOG- Bulldog Thermal Tumbler
RESERVE WINNERS DOG - Car-Pet for Car Window
WINNERS BITCH - Bulldog Thermal Tumbler
RESERVE WINNERS BITCH - Car-Pet for Car Window

CHOW CHOWS

THE MIDDLE TENNESSEE CHOW CHOW FANCIERS SUPPORTS THE ENTRY OF ITS BREED AT THIS SHOW.

Best of Breed
Best of Opposite Sex to Best of Breed
Winners Dog/Winners Bitch
THREE STREAMER ROSETTE

Offered by the Tri-Star Kennel Club of Williamson County, Tennessee

The following prizes will be a Guitar Shaped Dog Toy offered by the Middle Tennessee Chow Chow Fanciers.

BEST OF BREED
BEST OF WINNERS
BEST OF OPPOSITE SEX TO BEST OF BREED
SELECT DOG
SELECT BITCH
WINNERS DOG
WINNERS BITCH

SCHIPPERKES

BEST OF BREED - Embroidered Towel offered by Jim & Jill Arthur

HERDING BREEDS

PULIK

DESIGNATED REGIONAL SPECIALTY

THE PULI CLUB OF AMERICA CONSIDERS THE CLASSES AT THIS SHOW AS ITS SPECIALTY SHOW.

OFFICERS

Jane Slade ExumPresident
Brian Brubaker.....Vice President
Linore Cleveland.....Treasurer
Kathy Allen.....Recording Secretary
Julie SchuhCorresponding Secretary

1616 E Calumet St, Appleton WI 94915

SWEEPSTAKES

REQUIREMENTS & CLASSIFICATION

Sweepstakes is open to all Pulik that are 6 months & under 18 months of age on the day of the show. Dogs shown in Sweepstakes must also be entered in one of the regular classes at the regular entry fee and on the regular entry form. Indicate your Sweepstakes Class with the age division in the space provided for "Additional Class."

The following classes will be provided for both dogs and bitches.

Junior, 6 Mos & Under 9 Mos • Junior, 9 Mos & Under 12 Mos
Senior, 12 Mos & Under 15 Mos • Senior, 15 Mos & Under 18 Mos

DIVISION OF ENTRY MONEY AS PRIZES

25% of total entry fees will be retained by the Club for expenses. The remaining 75% will be divided in each class as follows: 1st - 40% • 2nd - 30% • 3rd - 20% • 4th - 10%

SWEEPSTAKES PRIZES

The following prizes are offered by the Puli Club of America.
BEST IN SWEEPSTAKES - Pillow with Sheep Design
BEST JUNIOR IN SWEEPSTAKES - Key Chain
BEST OF OPPOSITE SEX TO BEST JUNIOR IN SWEEPSTAKES - Key Chain
BEST SENIOR IN SWEEPSTAKES - Key Chain
BEST OF OPPOSITE SEX TO BEST SENIOR IN SWEEPSTAKES - Key Chain
FIRST IN EACH CLASS - Towel with Logo
SECOND, THIRD & FOURTH IN EACH CLASS - Sheep Toy

VETERAN SWEEPSTAKES

REQUIREMENTS & CLASSIFICATION

Veteran Sweepstakes is open to all Puli that are 7 years of age or older on the day of the show. Dogs shown in Veteran Sweepstakes need not be entered in one of the regular classes or at the regular entry fee. Indicate your Veteran Sweepstakes Class with the age division in the space provided. Spayed or neutered veterans may enter this Veteran Sweepstakes.

The following classes will be provided for both dogs and bitches.

Veteran, 7 Yrs & Under 10 Yrs • Veteran, 10 Yrs & Older

First Place winners in each class of Veterans 7-10 Yrs will compete for Best 7-10 Yrs in Veteran Sweepstakes & Best of Opposite Sex to Best 7-10 Yrs in Veteran Sweepstakes

First Place winners in each class of Veterans 10 Yrs & Older will compete for Best 10 Yrs & Older in Veteran Sweepstakes & Best of Opposite Sex to Best 10 Yrs & Older in Veteran Sweepstakes

Best 7-10 Yrs in Veteran Sweepstakes & Best 10 Yrs & Older in Veteran Sweepstakes will then compete for Best in Veteran Sweepstakes

DIVISION OF ENTRY MONEY AS PRIZES

25% of total entry fees will be retained by the Club for expenses. The remaining 75% will be divided as follows: First - 40%; Second - 30%; Third - 20%; Fourth - 10%.

**THERE WILL BE COMPETITION FOR BEST PUPPY IN PUPPY CLASSES,
BEST BRED-BY-EXHIBITOR & BEST VETERAN**

REGULAR CLASS PRIZES

The following prizes are offered by the Puli Club of America.
BEST OF BREED - Embroidered Chair
BEST OF WINNERS - Embroidered Duffle Bag
BEST OF OPPOSITE SEX TO BEST OF BREED - Embroidered Cooler
SELECT DOG - Embroidered Stadium Blanket
SELECT BITCH - Embroidered Stadium Blanket
WINNERS DOG - Embroidered Grooming Apron
RESERVE WINNERS DOG - Embroidered Grommeted Hand Towel
WINNERS BITCH - Embroidered Grooming Apron
RESERVE WINNERS BITCH - Embroidered Grommeted Hand Towel
BEST OWNER-HANDLED - Embroidered Tote
BEST PUPPY IN PUPPY CLASSES - Embroidered Tote
BEST BRED-BY-EXHIBITOR - Embroidered Tote
BEST VETERAN - Embroidered Tote
FIRST IN EACH CLASS - Towel with Legs

AWARDS OF MERIT

Following the Best of Breed/Variety, Best of Opposite Sex to Best of Breed/Variety and Selects have been awarded; the judge may select Award of Merit Winners from the remaining dogs and bitches in competition. The number of these awards is 10% of the Total Entry. These Awards of Merit are reserved for those quality animals the judge feels are worthy of final consideration for Best of Breed. The dogs selected for Best of Breed, Best of Opposite Sex to Best of Breed, Select Dog, & Select Bitch are not eligible for an Award of Merit. Each Award of Merit will receive a Large Embroidered Towel offered by the Puli Club of America.

JUNIOR SHOWMANSHIP COMPETITION PRIZES

Unless otherwise indicated, the following prizes are offered by the Tri-Star Kennel Club of Williamson County, Tennessee.

BEST JUNIOR HANDLER - Embroidered Towel offered by Bett Pilling

BEST JUNIOR HANDLER - 3 Streamer Rosette

RESERVE BEST JUNIOR HANDLER - 3 Streamer Rosette



The following prizes are offered by the Junior Achievement Challenge.

FIRST IN EACH CLASS - 1 Group of AKC Breed Standards (Junior's Choice)

**SUNDAY
BEST IN SHOW & VARIETY GROUP PRIZES**

FOR BEST IN SHOW

COUNTRY MUSIC GUITAR

Offered by George Guhn

BABY BLUE, RED & WHITE ROSETTE

Offered by the Tri-Star Kennel Club of Williamson County, Tennessee

FOR RESERVE BEST IN SHOW

BLACK & GOLD ROSETTE

Offered by the Tri-Star Kennel Club of Williamson County, Tennessee

FOR BEST OWNER-HANDLED IN SHOW

POLO SHIRT AUTOGRAPHED BY COUNTRY MUSIC STARS
Offered by Thomas, Tondalea' & Peggy Wright, Tomjo Kennels
ROSETTE

Offered by the Tri-Star Kennel Club of Williamson County, Tennessee

FOR RESERVE BEST OWNER-HANDLED IN SHOW

ROSETTE

Offered by the Tri-Star Kennel Club of Williamson County, Tennessee

FOR FIRST IN EACH REGULAR VARIETY GROUP

HAND HELD GUITAR TROPHY

Sporting Group

Offered by Helene Guida, Pinewood Kennels

Hound Group

Offered by Linda Winford & Kathy Lyons, Southridge Kennels

Working Group

Offered by Cheryl Green, Al'Cher Dobermans

Terrier Group

Offered by Claudia Seaberg

Toy Group

Offered by Chinese Crested Club of Nashville

Non-Sporting Group

Offered by Music City Bulldog Club

Herding Group

Offered by Tim McCormack & Bryan McMillen, Treasure Chest Boxers

FOR FIRST IN EACH OWNER-HANDLED VARIETY GROUP

EMBROIDERED TOWEL

Sporting Group

Offered by Sally Sklar

Hound Group

Offered by Paul Hines

Working Group

Offered by Bryan McMillen

Terrier Group

Offered by Anne Kieffer, Fritz Fox Terriers

Toy Group

Offered by Dick Dickerson

Non-Sporting Group

Offered by Jill & Jim Arthur

Herding Group

Offered by Claudia Seaberg

FOR FIRST, SECOND, THIRD & FOURTH IN EACH REGULAR VARIETY GROUP

ROSETTE

Offered by the Tri-Star Kennel Club of Williamson County, Tennessee

FOR FIRST, SECOND, THIRD & FOURTH IN EACH OWNER-HANDLED VARIETY GROUP

ROSETTE

Offered by the Tri-Star Kennel Club of Williamson County, Tennessee

BREED PRIZES

Tri-Star Kennel Club of Williamson County, Tennessee offers a \$50.00 Gift Card for Winners Dog and/or Winners Bitch for every Breed where entries stipulate a 5 point major in their class.

HOUND BREEDS

BASENJIS

BEST OF BREED - Food Bowl filled with Treats offered by Thomas, Tondalea' & Peggy Wright, Tomjo Kennels

DACHSHUNDS (LONGHAIRD)

THE CUMBERLAND VALLEY DACHSHUND CLUB SUPPORTS THE ENTRY OF ITS BREED AT THIS SHOW.

Best of Variety
Best of Opposite Sex to Best of Variety
Winners Dog/Winners Bitch

THREE STREAMER ROSETTE

Offered by the Tri-Star Kennel Club of Williamson County, Tennessee

DACHSHUNDS (SMOOTH)

THE CUMBERLAND VALLEY DACHSHUND CLUB SUPPORTS THE ENTRY OF ITS BREED AT THIS SHOW.

Best of Variety
Best of Opposite Sex to Best of Variety
Winners Dog/Winners Bitch

THREE STREAMER ROSETTE

Offered by the Tri-Star Kennel Club of Williamson County, Tennessee

DACHSHUNDS (WIREHAIRD)

THE CUMBERLAND VALLEY DACHSHUND CLUB SUPPORTS THE ENTRY OF ITS BREED AT THIS SHOW.

Best of Variety
Best of Opposite Sex to Best of Variety
Winners Dog/Winners Bitch

THREE STREAMER ROSETTE

Offered by the Tri-Star Kennel Club of Williamson County, Tennessee

IRISH WOLFHOUNDS

BEST OF BREED - Gift Basket (Value \$10.00) offered by Chuck & Laura Dunn, Dalwhinnie Farm PRTs, Portland TN

WORKING BREEDS

BOXERS

THE EAST TENNESSEE BOXER CLUB SUPPORTS THE ENTRY OF ITS BREED AT THIS SHOW.

Best of Breed
Best of Opposite Sex to Best of Breed
Winners Dog/Winners Bitch

THREE STREAMER ROSETTE

Offered by the Tri-Star Kennel Club of Williamson County, Tennessee

The following prizes will be a Deluxe Treat & Toy Basket & are offered by the East Tennessee Boxer Club.

BEST OF BREED
BEST OF OPPOSITE SEX TO BEST OF BREED
WINNERS DOG
WINNERS BITCH

DOBERMAN PINCHERS

THE DOBERMAN PINSCHER CLUB OF NASHVILLE SUPPORTS THE ENTRY OF ITS BREED AT THIS SHOW.

Best of Breed
Best of Opposite Sex to Best of Breed
Winners Dog/Winners Bitch

THREE STREAMER ROSETTE

Offered by the Tri-Star Kennel Club of Williamson County, Tennessee

NEAPOLITAN MASTIFFS

THE UNITED STATES NEAPOLITAN MASTIFF CLUB SUPPORTS THE ENTRY OF ITS BREED AT THIS SHOW.

Best of Breed
Best of Opposite Sex to Best of Breed

ROSETTE

Offered by the United States Neapolitan Mastiff Club

Winners Dog/Winners Bitch

THREE STREAMER ROSETTE

Offered by the Tri-Star Kennel Club of Williamson County, Tennessee

BEST OF BREED - Cooling Coat & Prize Bucket (Value \$35.00) offered by Mariano Morales, Macas Molossus Neapolitan Mastiffs

BEST OF OPPOSITE SEX TO BEST OF BREED - Cooling Coat & Prize Bucket (Value \$35.00) offered by Mary & Brian Ham, Redbarn Mastiffs

TERRIER BREEDS

PARSON RUSSELL TERRIERS

The following prizes are offered by Chuck & Laura Dunn, Dalwhinnie Farm PRTs, Portland TN.

BEST OF BREED - Gift Basket (Value \$10.00)

BEST OF OPPOSITE SEX TO BEST OF BREED - Gift Basket (Value \$10.00)

WINNERS DOG - Dog Toy

WINNERS BITCH - Dog Toy

TOY BREEDS

CHINESE CRESTEDS

THE CHINESE CRESTED CLUB OF NASHVILLE SUPPORTS THE ENTRY OF ITS BREED AT THIS SHOW.

Best of Breed
Best of Opposite Sex to Best of Breed

Winners Dog/Winners Bitch

THREE STREAMER ROSETTE

Offered by the Tri-Star Kennel Club of Williamson County, Tennessee

HAVANESE

THE HAVANESE CLUB OF AMERICA SUPPORTS THE ENTRY OF ITS BREED AT THIS SHOW.

Best of Breed
Best of Opposite Sex to Best of Breed

Winners Dog/Winners Bitch

THREE STREAMER ROSETTE

Offered by the Tri-Star Kennel Club of Williamson County, Tennessee

TOY FOX TERRIERS

Best of Breed
Best of Opposite Sex to Best of Breed

Winners Dog/Winners Bitch

THREE STREAMER ROSETTE

Offered by the Tri-Star Kennel Club of Williamson County, Tennessee

The following prizes will be a Water Bucket & are offered by Anne Kieffer.

BEST OF BREED

BEST OF OPPOSITE SEX TO BEST OF BREED

SELECT DOG

SELECT BITCH

NON-SPORTING BREEDS

BULLDOGS

THE MUSIC CITY BULLDOG CLUB SUPPORTS THE ENTRY OF ITS BREED AT THIS SHOW.

Best of Breed
Best of Opposite Sex to Best of Breed
Winners Dog/Winners Bitch

THREE STREAMER ROSETTE

Offered by the Tri-Star Kennel Club of Williamson County, Tennessee

The following prizes are offered by the Music City Bulldog Club.

BEST OF BREED - Hanging Garment Bag
BEST OF WINNERS - Bulldog Bank
BEST OF OPPOSITE SEX TO BEST OF BREED - Bulldog Plaque
WINNERS DOG - Bulldog Thermal Tumbler
RESERVE WINNERS DOG - Car-Pet for Car Window
WINNERS BITCH - Bulldog Thermal Tumbler
RESERVE WINNERS BITCH - Car-Pet for Car Window

CHOW CHOWS

THE MIDDLE TENNESSEE CHOW CHOW FANCIERS SUPPORTS THE ENTRY OF ITS BREED AT THIS SHOW.

Best of Breed
Best of Opposite Sex to Best of Breed
Winners Dog/Winners Bitch

THREE STREAMER ROSETTE

Offered by the Tri-Star Kennel Club of Williamson County, Tennessee

The following prizes will be a Guitar Shaped Dog Toy & are offered by Middle Tennessee Chow Fanciers.

BEST OF BREED
BEST OF WINNERS
BEST OF OPPOSITE SEX TO BEST OF BREED
SELECT DOG
SELECT BITCH
WINNERS DOG
WINNERS BITCH

SCHIPPERKES

BEST OF BREED - Embroidered Towel offered by Jim & Jill Arthur

HERDING BREEDS

PULIK

THE PULI CLUB OF AMERICA SUPPORTS THE ENTRY OF ITS BREED AT THIS SHOW.

Best of Breed
Best of Opposite Sex to Best of Breed
Winners Dog/Winners Bitch

THREE STREAMER ROSETTE

Offered by the Tri-Star Kennel Club of Williamson County, Tennessee

The following prizes are offered by the Puli Club of America.

BEST OF BREED - Soft Sided Crate
BEST OF WINNERS - Cool Mat
BEST OF OPPOSITE SEX TO BEST OF BREED - Travel Bag
WINNERS DOG - First Aid Kit
WINNERS BITCH - First Aid Kit

JUNIOR SHOWMANSHIP COMPETITION PRIZES

BEST JUNIOR HANDLER - Embroidered Towel offered by Bett Pilling

BEST JUNIOR HANDLER - 3 Streamer Rosette offered by the Tri-Star Kennel Club of Williamson County, Tennessee

RESERVE BEST JUNIOR HANDLER - 3 Streamer Rosette offered by the Tri-Star Kennel Club of Williamson County, Tennessee



The following prizes are offered by the Junior Achievement Challenge.

FIRST IN EACH CLASS - 1 Group of AKC Breed Standards (Junior's Choice)

Tri-Star Kennel Club of Williamson County, TN

B Match

Saturday, October 14, 2017

Helene Guida, Match Chairperson

Judges

| | | |
|---------------------|-----------------|--------------------|
| Sporting: | Becky Blansett | Dayton, OH |
| Hound: | Becky Blansett | Dayton, OH |
| Working: | Beth Downey | Ocean Springs, MS |
| Terrier: | Sally Sklar | Portland, TN |
| Toy: | Anne Kieffer | Scottsville, TN |
| Non--Sporting: | Chauncey Vaughn | Brentwood, TN |
| Herding: | Beth Downey | Ocean Springs, MS |
| Junior Showmanship: | Sally Sklar | Portland, TN |
| Best in Show Pup: | Daniel Fabelo | Indian Springs, OH |
| Best in Show Adult: | Daniel Fabelo | Indian Springs, OH |

Classes

Puppy: *4-6 month, 6-9 months and 9-12 months*

Adult: *all dogs over 12 months*

Trophies donated by: Bill & Celeste Neil, Danny & Judy Russell & Tri-Star Kennel Club of Williamson County, Tennessee

Entries

\$5.00 per dog

- No Pre-entries

- *Entries taken only on October 14, 2017 from 9:00 AM to the start of the All-Breed Best in Show.*

The "B" Match will begin 30 minutes after Best in Show.

Handlers may show "only" dogs they own.

No Major Pointed Dogs may be entered.

Tri Star Kennel Club of Williamson County, TN Overnight Parking Reservation Form

Name: _____

Phone: _____ Cell Phone: _____

Address: _____

City/State/Zip Code: _____

Email address (for notification): _____

Arrival Date: _____ Departure Date: _____

RV Length: _____ State/License Tag: _____

RV Type: Class A Motor Home _____ Class C Motor Home _____

Van _____ Pop Up _____ Travel Trailer _____ Fifth Wheeler _____

**Cost of parking will be \$35.00 per night.
There will be "NO REFUNDS."**

Total Amount Enclosed: _____

Signature _____

Please mail this form, payment (check or money order)

and

Self-addressed envelope to Kathy Lyons and Linda Winford

1559 Old Dotsonville Rd, Clarksville TN 37204

Email: soridge@aol.com

Cell: (931) 220--1278

Frozen Semen Collection Frozen Semen Collection

AWC-Animal Wellness Center, Gordonsville TN,
Julia Adams, DVM

AKC Approved frozen semen storage facility will collect, evaluate, process & freeze semen in liquid nitrogen to be stored here in Middle Tennessee.

Fee: (Show Special)

- **\$375.00** for initial collection, evaluation & one year storage at our clinic in Middle Tennessee for as many straws as he produces.
- **\$300.00** for additional collection of same stud.

Annual storage fee after first year:

For one dog, **\$100.00** per year.

Requirements:

- Bring a copy of his AKC registration papers with you.
- AKC requires DNA - Bring DNA certificate or kits will be available.
- Brucellosis within 6 months of collection or test will be available.
- AKC recommends a Microchip (available at show) or Tattoo for ID purposes.

Questions:

Contact Kathy, Reproduction Administrator
(615) 683-6600 • Email awcfront@yahoo.com • Website www.awctennessee.com

Early Reservation is suggested.
Reserve early for your preferred appointment time.

Mail completed AWC/CLONE Client form & Reservation Form to
Animal Wellness Center,
259 JMZ Dr, Gordonsville TN 38563
or Fax to: (615) 683-6629.

Semen Collection Pre-Registration Form

Dog's Registered Name

Call Name.....

Breed.....AKC #.....

Check day preferred for Collection:

Thurs ____ Fri ____ Sat ____

Your Name.....

Phone Number.....

E-mail.....

For clinic use only:
provided needed DNA ____
Brucellosis Test ____
Microchip ____
Copy of AKC Papers ____

OFFICIAL AMERICAN KENNEL CLUB ENTRY FORM
BOTH SIDES OF ENTRY FORM MUST BE SUBMITTED

Appropriate Box(es) MUST BE CHECKED

**TRI-STAR KENNEL CLUB OF
WILLIAMSON COUNTY, TENNESSEE**

SATURDAY, OCTOBER 14, 2017 • SUNDAY, OCTOBER 15, 2017

Wilson County Exposition Center
945 East Baddour Parkway • Lebanon, Tennessee 37087

See page 2 for entry fees

ENTRIES CLOSE WEDNESDAY NOON, SEPTEMBER 27, 2017 or when the numerical limit has been reached, if reached prior to this date at Superintendent's Office. (See limit on page 1)

MAIL ENTRIES with Fees Payable to **JACK ONOFRIO**, PO Box 25764, Oklahoma City, Oklahoma 73125-0764 or West Coast exhibitors: PO Box 4660, Portland, Oregon 97208-4660.

NOTICE: PLEASE PUT BREED & NAME OF SHOW ON CHECKS. I ENCLOSE \$_____ for entry fees.

IMPORTANT - Read instructions on reverse side carefully before filling out. Numbers in the boxes indicate sections of the instructions relevant to the information needed in that box (PLEASE PRINT). Next, be sure to read the Agreement and sign on the reverse. No form will be processed without your signature!

| | | |
|---|---|----------------------------------|
| Breed (5) | Variety (1) | Sex |
| Dog Show Class (2) (3) | Class (3) Division (Weight, Color, Etc.) | |
| Additional Classes | Obedience Class (Jump Height) | Rally Class (Jump Height) |
| | | Junior Showmanship Class |
| Name of (See Back) Junior Handler (if any) | | Junior Handler Number |
| Full Name of Dog | | |

| | | |
|--|---|----------------------|
| <input type="checkbox"/> AKC® No. <input type="checkbox"/> PAL/ILP No. <input type="checkbox"/> Foreign Reg. No. <small>Enter number here</small> | Place of Birth (enter country below) <i>Do not print the country in catalog</i> | Date of Birth |
|--|---|----------------------|

Breeder

Sire

Dam

Exhibitor's Code

Actual Owner(s) (4)
(Please Print)

Owner's Address

| | | |
|--------------------|---|--|
| City | State/Prov | ZIP + 4 |
| Telephone # | Are you a new exhibitor? Yes <input type="checkbox"/> No <input type="checkbox"/> | Owner-Handled Eligible? Yes <input type="checkbox"/> No <input type="checkbox"/> |

Email Address (an acknowledgement or receipt of entry may be sent to this email address)

Name of Agent at the Show (if any) **CODE #**

*** Be Sure to read the Agreement and sign on the reverse. No form will be processed without your signature! ***

AGREEMENT

I CERTIFY that I am the actual owner of the dog, or that I am the duly authorized agent of the actual owner whose name I have entered above. In consideration of the acceptance of this entry, I (we) agree to abide by the rules and regulations of the American Kennel Club in effect at the time of this event, and by any additional rules and regulations appearing in the premium list for this event, and further agree to be bound by the "Agreement" printed on the reverse side of this entry form. I (we) certify and represent that the dog entered is not a hazard to persons or other dogs. This entry is submitted for acceptance on the foregoing representation and Agreement. I (we) agree to conduct myself (ourselves) in accordance with all such Rules and Regulations (including all provisions applying to discipline) and to abide by any decisions made in accord with them. I (we) agree that the club holding this event has the right to refuse this entry for cause which the club shall deem sufficient. In consideration of the acceptance of this entry and of the holding of this event and of the opportunity to have the dog judged and to win prizes, ribbons, or trophies, I (we) agree to hold the AKC, the event-giving club, their members, directors, governors, officers, agents, superintendents or event secretary and the owner and/or lessor of the premises and any provider of services that are necessary to hold this event and any employees or volunteers of the aforementioned parties, and any AKC approved judge, judging at this event, harmless from any claim for loss or injury which may be alleged to have been caused directly or indirectly to any person or thing by the act of this dog while in or about the event premises or grounds or near any entrance thereto, and I (we) personally assume all responsibility and liability for any such claim; and I (we) further agree to hold the aforementioned parties harmless from any claim for loss, injury or damage to this dog. Additionally, I (we) hereby assume the sole responsibility for and agree to indemnify, defend and save the aforementioned parties harmless from any and all loss and expense (including legal fees) by reason of the liability imposed by law upon any of the aforementioned parties for damage because of bodily injuries, including death at any time resulting therefrom, sustained by any person or persons, including myself (ourselves) or on account of damage to property, arising out of or in consequence of my (our) participation in this event, however such injuries, death or property damage may be caused, and whether or not the same may have been caused or may be alleged to have been caused by the negligence of the aforementioned parties or any of their employees, agents, or any other persons. I (we) agree that the determination of whether the injury is serious shall be made by the event veterinarian and is binding on me (us). **I (WE) AGREE THAT ANY CAUSE OF ACTION, CONTROVERSY OR CLAIM ARISING OUT OF OR RELATED TO THE ENTRY, EXHIBITION OR ATTENDANCE AT THE EVENT BETWEEN THE AKC AND THE EVENT-GIVING CLUB (UNLESS OTHERWISE STATED IN ITS PREMIUM LIST) AND MYSELF (OURSELVES) OR AS TO THE CONSTRUCTION, INTERPRETATION AND EFFECT OF THIS AGREEMENT SHALL BE SETTLED BY ARBITRATION PURSUANT TO THE APPLICABLE RULES OF THE AMERICAN ARBITRATION ASSOCIATION. HOWEVER, PRIOR TO ARBITRATION ALL APPLICABLE AKC BYLAWS, RULES, REGULATIONS AND PROCEDURES MUST FIRST BE FOLLOWED AS SET FORTH IN THE AKC CHARTER AND BYLAWS, RULES, REGULATIONS, PUBLISHED POLICIES AND GUIDELINES.**

Signature of owner or his agent
duly authorized to make this entry:

Telephone

Email

INSTRUCTIONS

- (Variety) if you are entering a dog of breed in which there are varieties for show purposes, please designate the particular variety you are entering i.e., Cocker Spaniel (solid color black, ASCOB, parti-color). Beagles (not exceeding 13 in. over 13 in. but not exceeding 15 in.). Dachshunds (longhaired, smooth, wirehaired), Bull Terriers (colored, white), Manchester Terriers (standard, toy), Chihuahuas (smooth coat, long coat), English Toy Spaniels (King Charles and Ruby, Blenheim and Prince Charles), Poodles (toy, miniature, standard), Collies (rough, smooth),
- The following categories of dogs may be entered and shown in Best of Breed competition; Dogs that are Champions of Record and dogs which, according to their owner's records, have completed the requirements for a championship, but whose championships are unconfirmed. The showing of unconfirmed Champions in Best of Breed competition is limited to a period of 90 days from the date of the show where the dog completed the requirements for a championship.
- (Event Class) Consult the classification in this premium list. If the event class in which you are entering your dog is divided, then, in addition to designating the class, specify the particular division of the class in which you are entering your dog, i.e., age division, color division, weight division.
- A dog must be entered in the name of the person who actually owned it at the time entries for an event closed. If a registered dog has been acquired by a new owner, it must be entered in the name of its new owner in any event for which entries closed after the date of acquirement, regardless of whether the new owner has received the registration certificate indicating that the dog is recorded in his name. State on entry form whether transfer application has been mailed to the A.K.C. (For complete rules refer to Chapter 11, Section 3).
- Mixed Breed dogs entering classes for Agility, Obedience and Rally trials should mark Breed as AKC Canine Partners Listed Dog "All-American Dog/Mixed Breed." Variety, Breeder, Sire, Dam information shall remain blank for mixed breed entrants.

JUNIOR SHOWMANSHIP. If this entry is for Jr Showmanship, please enter the following information:

AKC JR HANDLER #

JR.'S DATE OF BIRTH

 / /

The Junior Handler number MUST be included. Should you not have your Junior Handler number, it may be obtained from the American Kennel Club, Phone (919) 233-9767.

Junior Handler's Address

City

State/Province

ZIP + 4

Country (if not USA)

By signing the entry form I (we) certify that the Junior Showman does not now, and will not at any time, act as an agent/handler for pay while continuing to compete in Junior Showmanship.

■ If Jr. Handler is not the owner of the dog identified on the face of this form, what is the relationship of the Jr. Handler to the owner?